

AMERICAN WEST WINDMILLS

COMPLETE WINDMILL HEADS

WHEEL DIAMETER	PUMPING STROKES	LIST PRICE	WEIGHT LBS.
X - 6 Feet	5" & 3 3/4"	please call or email for prices	197
A - 8 Feet	7 1/8" & 5 1/2"		341
B - 10 Feet	9 1/4" & 7 1/4"		613
D - 12 Feet	11 1/4" & 8 1/4"		1,110
E - 14 Feet	13 1/2" & 9 3/4"		1,624
F - 16 Feet	14 7/8" & 11 3/8"		2,452

CRATED MOTOR

LIST PRICE	WEIGHT LBS.
please call or email for prices	92
	159
	308
	492
	741
	1,236

MAJOR WINDMILL COMPONENTS

BASIC MOTOR		
WHEEL DIAMETER	LIST PRICE	WEIGHT LBS.
X - 6 Feet	please call or email for prices	85
A - 8 Feet		146
B - 10 Feet		285
D - 12 Feet		451
E - 14 Feet		676
F - 16 Feet		1,146

NO. 20 FURL BRAKE KIT		
WHEEL DIAMETER	LIST PRICE	WEIGHT LBS.
X - 6 Feet	please call or email for prices	8
A - 8 Feet		13
B - 10 Feet		23
D - 12 Feet		41
E - 14 Feet		65
F - 16 Feet		90

NO. 31 VANE		
WHEEL DIAMETER	LIST PRICE	WEIGHT LBS.
X - 6 Feet	please call or email for prices	7
A - 8 Feet		11
B - 10 Feet		13
D - 12 Feet		30
E - 14 Feet		60
F - 16 Feet		92

NO. 664 MAST COMPLETE		
WHEEL DIAMETER	LIST PRICE	WEIGHT LBS.
X - 6 Feet	please call or email for prices	17
A - 8 Feet		20
B - 10 Feet		38
D - 12 Feet		61
E - 14 Feet		105
F - 16 Feet		141

NO. 747 TAIL ASSEMBLY		
WHEEL DIAMETER	LIST PRICE	WEIGHT LBS.
X - 6 Feet	please call or email for prices	15
A - 8 Feet		30
B - 10 Feet		44
D - 12 Feet		85
E - 14 Feet		118
F - 16 Feet		148

NO. 800 TAIL ASSEMBLY 31-VANE, 639-TAILBONE, 510-PIN		
WHEEL DIAMETER	LIST PRICE	WEIGHT LBS.
X - 6 Feet	please call or email for prices	15
A - 8 Feet		30
B - 10 Feet		44
D - 12 Feet		85
E - 14 Feet		118
F - 16 Feet		148

NO. 799 WHEEL COMPLETE		
WHEEL DIAMETER	LIST PRICE	WEIGHT LBS.
X - 6 Feet	please call or email for prices	65
A - 8 Feet		121
B - 10 Feet		210
D - 12 Feet		348
E - 14 Feet		600
F - 16 Feet		835

AMERICAN WEST WINDMILLS

STUB TOWERS AND COMPLETE TOWERS

MILL SIZE	6' & 8'	
CORNER POSTS	* 2" X 2" X 3/16"	
TOWER HEIGHT	PRICE	WEIGHT
3' STUB	call or email for prices	35 lbs.
4' STUB		75 lbs.
5' STUB		
7' STUB		105 lbs.
21' TOWER		440 lbs.
27' TOWER		480 lbs.
33' TOWER		650 lbs.
40' TOWER		760 lbs.
47' TOWER		910 lbs.
4 ANCHOR POST		83 lbs.

MILL SIZE	10'	
CORNER POSTS	* 2 1/2" X 2 1/2" X 3/16"	
TOWER HEIGHT	PRICE	WEIGHT
3' STUB	call or email for prices	40 lbs.
4' STUB		
5' STUB		100 lbs.
7' STUB		125 lbs.
21' TOWER		485 lbs.
27' TOWER		595 lbs.
33' TOWER		690 lbs.
40' TOWER		820 lbs.
47' TOWER		950 lbs.
4 ANCHOR POST		95 lbs.

MILL SIZE	12'	
CORNER POSTS	* 2 1/2" X 2 1/2" X 3/16"	
TOWER HEIGHT	PRICE	WEIGHT
4' STUB	call or email for prices	100 lbs.
7' STUB		160 lbs.
27' TOWER		770 lbs.
33' TOWER		945 lbs.
40' TOWER		1120 lbs.
47' TOWER		1430 lbs.
4 ANCHOR POST		112 lbs.

MILL SIZE	14'	
CORNER POSTS	* 3" X 3" X 3/16"	
TOWER HEIGHT	PRICE	WEIGHT
4' STUB	call or email for prices	80 lbs.
7' STUB		185 lbs.
27' TOWER		870 lbs.
33' TOWER		1045 lbs.
40' TOWER		1260 lbs.
47' TOWER		1570 lbs.
4 ANCHOR POST		240 lbs.

MILL SIZE	16'	
CORNER POSTS	* 3" X 3" X 1/4"	
TOWER HEIGHT	PRICE	WEIGHT
7' STUB	call or email for prices	260 lbs.
33' TOWER		1330 lbs.
40' TOWER		1690 lbs.
4 ANCHOR POST		292 lbs.

NOTES:

* Steel of appropriate size may be substituted for corner post sizes indicated in the above chart.

a-Platform NOT Included.

b-Regular Platform Included.

c-Oiling Platform Included.

d-Regular & Oiling Platform Included.

GALVANIZED METAL PLATFORMS WITH BOLTS

MILL SIZE	REGULAR PLATFORMS			OILING PLATFORMS		
	PART NO.	PRICE	WEIGHT	PART NO.	PRICE	WEIGHT
6' & 8'	M-149	call or email for prices	30 lbs.		---	
10'	M-151		35 lbs.		---	
12'	M-249		55 lbs.	M-249 1/2	call or email for prices	15 lbs.
14'	M-279		60 lbs.	M-382		15 lbs.
16'	M-749		130 lbs.	M-383		15 lbs.

WINDMILL OIL

WINDMILL OIL	LIST PRICE	WEIGHT LBS.
Case of 24 one-quart containers	call or email for prices	46
5 Gallon Bucket		35
55 Gallon Drum (N/R Drum)	On Request	470

OIL REQUIRED			
SIZE	QTS.	SIZE	QTS.
X-6'	1	D-12'	4.00
A-8'	2	E-14'	8.00
B-10'	2	F-16'	8.00

Use ONLY non-detergent oil, lighter than No. 10 and free flowing in all weather in the locales of the windmill installation. The use of other types of lubricants may seriously damage the windmill and void the warranty.

AMERICAN WEST WINDMILLS

BOX OF BOLTS - WINDMILLS

WHEEL DIAMETER	BASIC MOTOR		WHEEL	
	PART NO.	PRICE	PART NO.	PRICE
6'	BOB-6BM	please call or email for prices	BOB X-799	please call or email for prices
8'	BOB-8BM		BOB A-799	
10'	BOB-10BM		BOB B-799	
12'	BOB-12BM		BOB D-799	
14'	BOB-14BM		BOB E-799	
16'	BOB-16BM		BOB F-799	

BOX OF BOLTS WITH STEPS - TOWERS

MILL SIZE	6' & 8'		10'	
TOWER HEIGHT	PART NO.	PRICE	PART NO.	PRICE
3' (3 POST)	BOB 8/3-3P	please call or email for prices	BOB 10/3-3P	please call or email for prices
3' & 4'	BOB 8/3-4		BOB 10/3-4	
5'			BOB 10/5	
7'	BOB 8/7		BOB 10/7	
21'	BOB 8/21		BOB 10/21	
27'	BOB 8/27		BOB 10/27	
33'	BOB 8/33		BOB 10/33	
40'	BOB 8/40		BOB 10/40	
47'	BOB 8/47		BOB 10/47	

MILL SIZE	12'		14'	
TOWER HEIGHT	PART NO.	PRICE	PART NO.	PRICE
3' & 4'	BOB 12/4	please call or email for prices	BOB 14/4	please call or email for prices
7'	BOB 12/7		BOB 14/7	
27'	BOB 12/27		BOB 14/27	
33'	BOB 12/33		BOB 14/33	
40'	BOB 12/40		BOB 14/40	
47'	BOB 12/47		BOB 14/47	REQUEST

MILL SIZE	16'	
TOWER HEIGHT	PART NO.	PRICE
7'	BOB 16/7	please call or email for prices
33'	BOB 16/33	
40'	BOB 16/40	
47'	BOB 16/47	REQUEST

TAPS	
DESCRIPTION	PRICE
6' 11/32 18V TAP	please call or email for prices
8' 13/32 16V TAP	
10' 15/32 12V TAP	
12' 19/32 13V TAP	
14' 23/32 11V TAP	
16' 25/32 10V TAP	

CLAMPS / BOLTS / STEPS - TOWERS

PART NO.	DESCRIPTION	PRICE
W-177	8' TOP TOWER CLAMP	please call or email for prices
W-179 1/2	10' TOP TOWER CLAMP	
W-277	12' TOP TOWER CLAMP	
W-274	14' TOP TOWER CLAMP	
W-777	16' TOP TOWER CLAMP	
W-779	16' TOP WASHER	
W-1062 1/2	8' TOP CLAMP 3 POST	
W-1068 1/2	10' TOP CLAMP 3 POST	
U-397	LOOP STEP	
W-148	PLATFORM BOLT 8' - 14'	
W-748	PLATFORM BOLT 16'	

DIES	
DESCRIPTION	PRICE
6' 11/32 18V DIE	please call or email for prices
8' 13/32 16V DIE	
10' 15/32 12V DIE	
12' 19/32 13V DIE	
14' 23/32 11V DIE	
16' 25/32 10V DIE	

AMERICAN WEST WINDMILLS

PARTS & ACCESSORIES

PART NO.	WHEEL DIAMETER	6'	8'	10'	12'	14'	16'
	ALPHA REFERENCE	X	A	B	D	E	F
	DESCRIPTION	PRICE					
20	FURL BRAKE KIT (1 Each 527, 585, 613, 659, 786)	SEE WINDMILL COMPONENTS					
28	VANE SPRING						
31	VANE	SEE WINDMILL COMPONENTS					
34	WHEEL BAND, OUTER	please call or email for prices					
35	WHEEL BAND, INNER						
44	U-BOLT, NARROW						
45	WASHER FOR 44	please call or email for prices	A-45		please call or email for prices		
46	U-BOLT, WIDE						
47	WASHER FOR 46		A-47				
51	PUMP POLE, WOOD	SPECIFICATION AVAILABLE FOR LOCAL PURCHASE					
62	CONNECTION, PUMP POLE WELL ROD*	A-62					
100	SAIL W/17 TIE	please call or email for prices					
101	SAIL RIB						
171	PUMP ROD COMPLETE						
172	PUMP ROD W/SWIVEL NUT ONLY						
243	FURL HANDLE COMPLETE	A-243	please call or email for prices				
268	SWIVEL FOR 171	A-263					
333	V-BOLT FOR FURL HANDLE	A-333	A-333		D-333		
334	V-BOLT FOR FURL HANDLE	A-334	A-334		D-334		
374	PUMP CONNECTION W/OPEN SIDE	A-374					
507	OIL RING	please call or email for prices					
508	PITMAN GUIDE W/588						
508R	RIVET FOR 508						
510	PIVOT BOLT FOR TAILBONE						
513	UPPER FURL RING, SPLIT						
517	SPRING FOR SPOUT WASHER						
520	OIL COLLECTOR						
521	SPLIT TURNTABLE WASHER						
522	SHAFT FOR GUIDE WHEEL/YOKE						
523	GUIDE WHEEL						
527	FURL LINK FOR 585, 786						
528	FURL ARM W/BUTTON HEAD						
528 1/2	FURL ARM, LONG FOR REPAIR	please call or email for prices					
528 3/4	FURL ARM, EXTRA LONG						
560	HELMET FOR GEAR CASE (GALVANIZED)						
565	NUT FOR 588-560	A-565	4.00	A-565		D-565	D-565
576	WASHER FOR TURNTABLE	please call or email for prices					
578	LOCKNUT FOR 661						
579	LOCKWASHER FOR 661						
580	SPRING HOLDER FOR 31, 28						
582	FURL WIRE	PURCHASE LOCALLY					
585	TAILBONE CASTING						

AMERICAN WEST WINDMILLS

PARTS & ACCESSORIES

PART NO.	WHEEL DIAMETER	6'	8'	10'	12'	14'	16'
	ALPHA REFERENCE	X	A	B	D	E	F
	DESCRIPTION	PRICE					
588	STUD FOR 508			A-588			
608	YOKE FOR 171 W/COTTER						
609	FURL LEVER COMPLETE, 4 POST						
610	PIN FOR 608						
613 1/2	FURL RING, UPPER, W/ARMS						
614	FURL RING, SPLIT FOR 609						
615	FURL RING, SPLIT FOR 670	X		X	X	X	X
622	BOLT W/COTTER FOR 686						
639	TAILBONE W/510						
659	BUFFER DEVICE COMPLETE						
661 1/2	MAST W/674 4 POST						
664 1/2	MAST W/674/609, 4 POST						
670	FURL COMPLETE, 3 POST				X	X	X
674	MAST BASE ONLY, 4 POST	A-674					
675	MAST BASE ONLY, 3 POST	A-675			X	X	X
686	PITMAN						
690	BRAKE COMPLETE						
702	MAIN FRAME	N/A	N/A	N/A	N/A	N/A	N/A
703	WHEEL HUB W/719						
704	SMALL GEAR						
705	LARGE GEAR						
708	BABBIT BEARING FOR 704'S						
711	SOCKET, OIL COLLECTOR						
718	SPOUT, OIL COLLECTOR						
720	SHAFT ON 705'S						
721	PIN ON 705'S						
729	PIN FOR 719						
730	BEARING FOR 719						
736	WHEEL ARM						
744	KEY FOR 704'S						
747	TAILBONE BUNDLE-ONE Ea. 639, 171, 28, 243						
751	BAR FOR 752						
752	BEARING FOR 720						
755	LARGE GEAR ASSEMBLY, 2 Ea. 705, 721, 1 Ea. 720, 752 ASSEMBLED						
770	BEARING KIT 1 Ea. 708, 730, 752, 729, 520, 2-721						
781	COUNTERSUNK PLUG FOR 702						
786	BRAKE LEVER						
799	WHEEL COMPLETE - 18 Ea. 100, 101, 12-736, 6 Ea. 34, 35 AND BOLTS						

please
call
or
email
for prices

please call or email
for prices

SEE WINDMILL COMPONENTS

please call or email
for prices

please
call
or
email
for prices

SEE WINDMILL COMPONENTS

please call or email
for prices

SEE WINDMILL COMPONENTS

please call or email
for prices

SEE WINDMILL COMPONENTS

AMERICAN WEST WINDMILLS

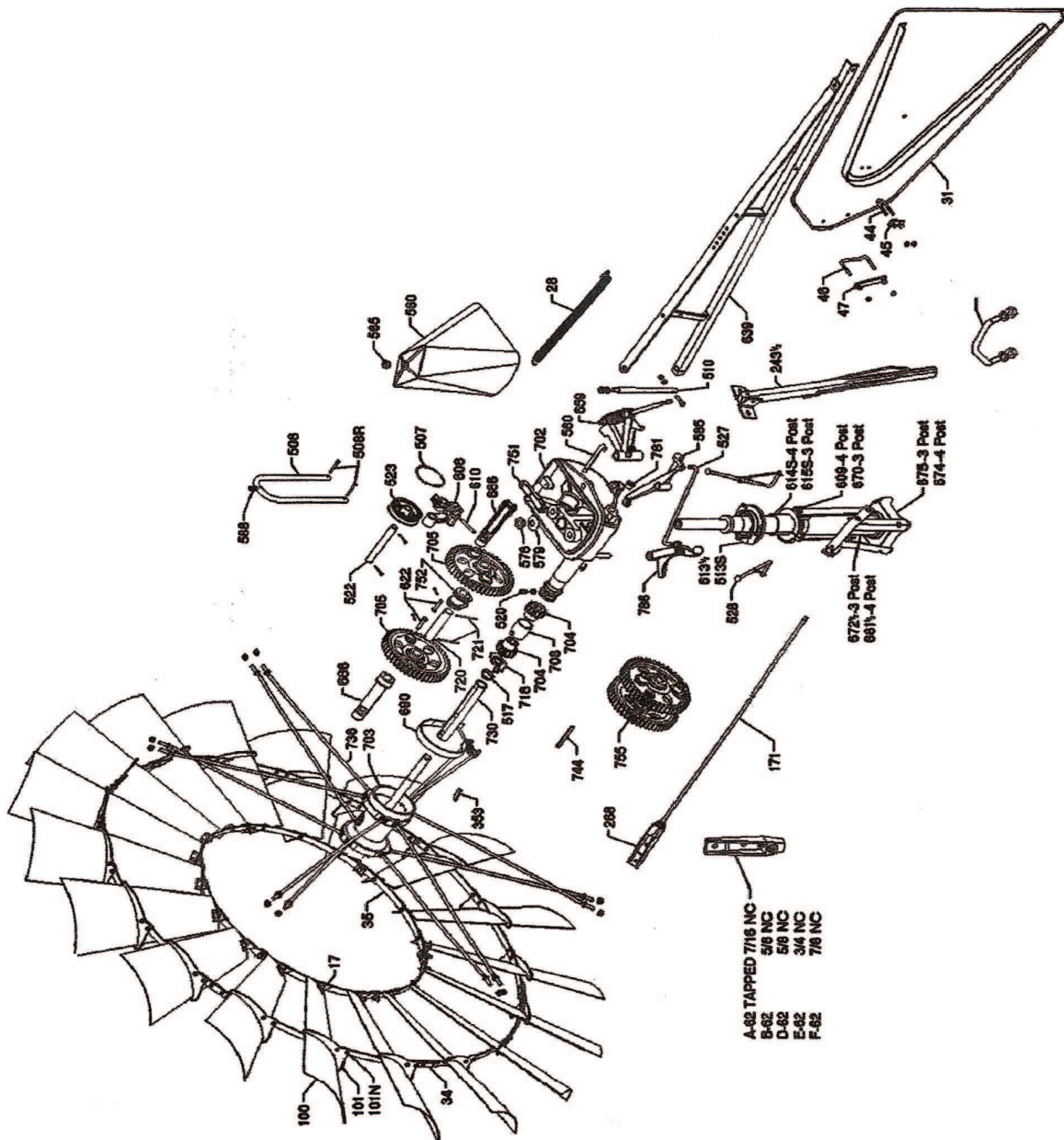

AMERICAN WEST WINDMILLS

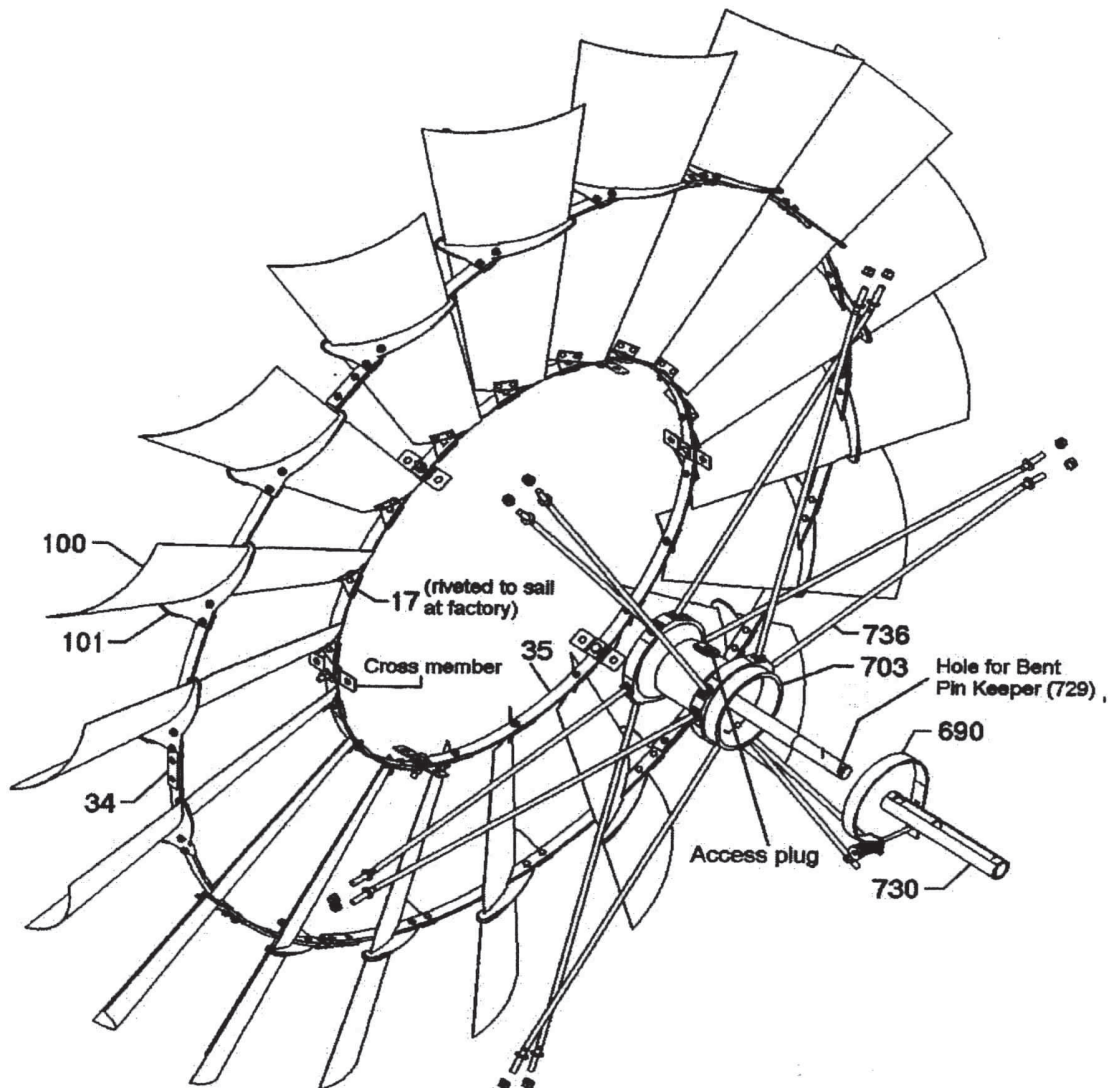

WHEEL ASSEMBLY PARTS

PART NO.	DESCRIPTION
100	Sail (Includes 17)
101	Sail Rib
34	Outer Wheel Band
35	Inner Wheel Band

PART NO.	DESCRIPTION
690	Brake Band
703	Wheel Hub Includes Main Shaft
730	Bearing for 703
736	Wheel Arm

AMERICAN WEST WINDMILLS

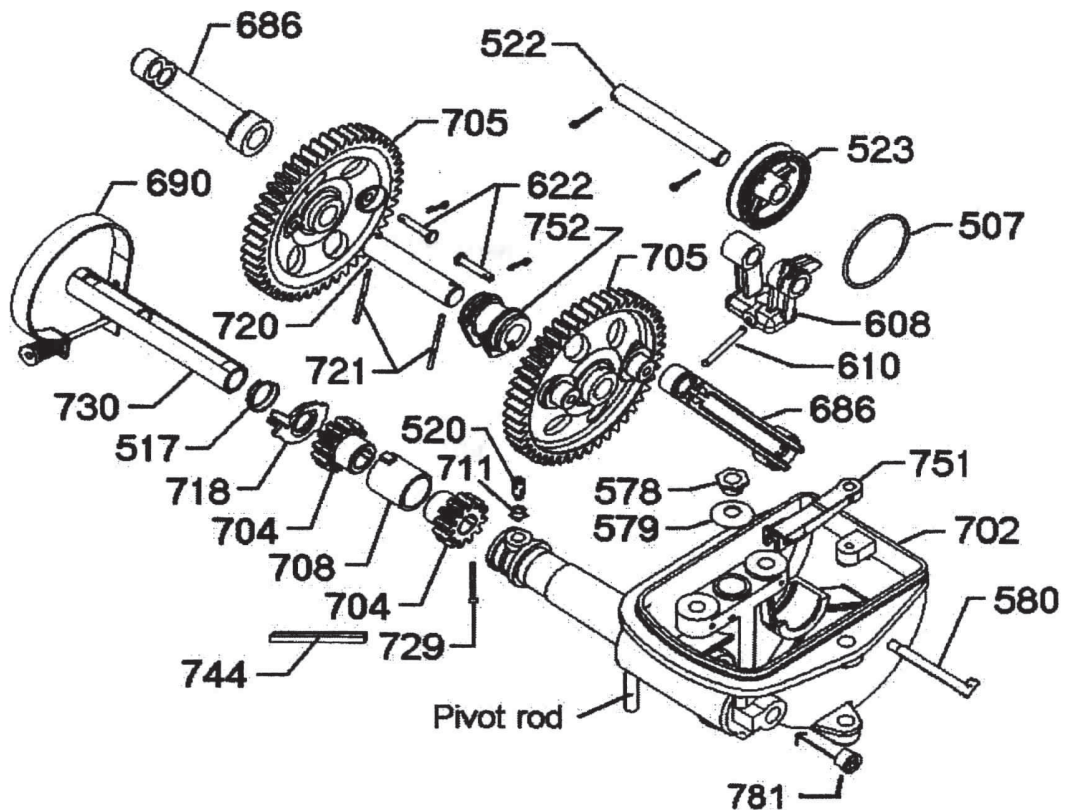

GEARBOX PARTS

PART NO.	DESCRIPTION
507	Oil Ring
517	Spring for Spout Washer
520	Oil Collector
522	Shaft for Guide Wheel
523	Guide Wheel
578	Locknut for 661
579	Lockwasher for 661
580	Spring Holder
608	Yoke
610	Pin for 608
622	Bolt W/Cotter
686	Pitman
702	Main Casting

PART NO.	DESCRIPTION
704	Small Gear
705	Large Gear
708	Bearings for 704's
711	Socket, Oil Collector
718	Spout, Oil Collector
720	Shaft for 705's
721	Pin for 705's
730	Bearing for 719 (703)
744	Key for 704's
751	Bar for 752
752	Bearing for 705's
781	Plug for 702 Main Casting

AMERICAN WEST WINDMILLS

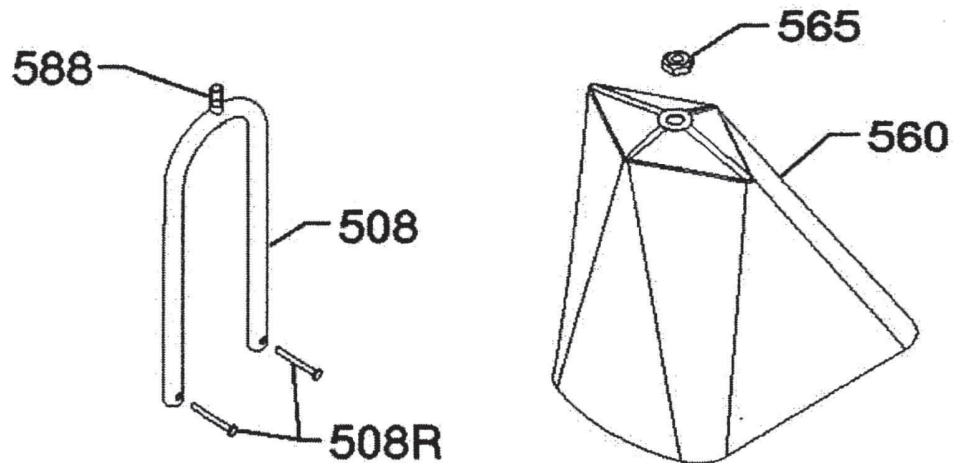

HELMET ASSEMBLY PARTS

PART NO.	DESCRIPTION
588	Stud for 508 Pitman Guide
508	Pitman Guide
508R	Rivet for 508 Pitman Guide

PART NO.	DESCRIPTION
560	Helmet for Gear Case Galvanized
565	Nut for 588-560

AMERICAN WEST WINDMILLS

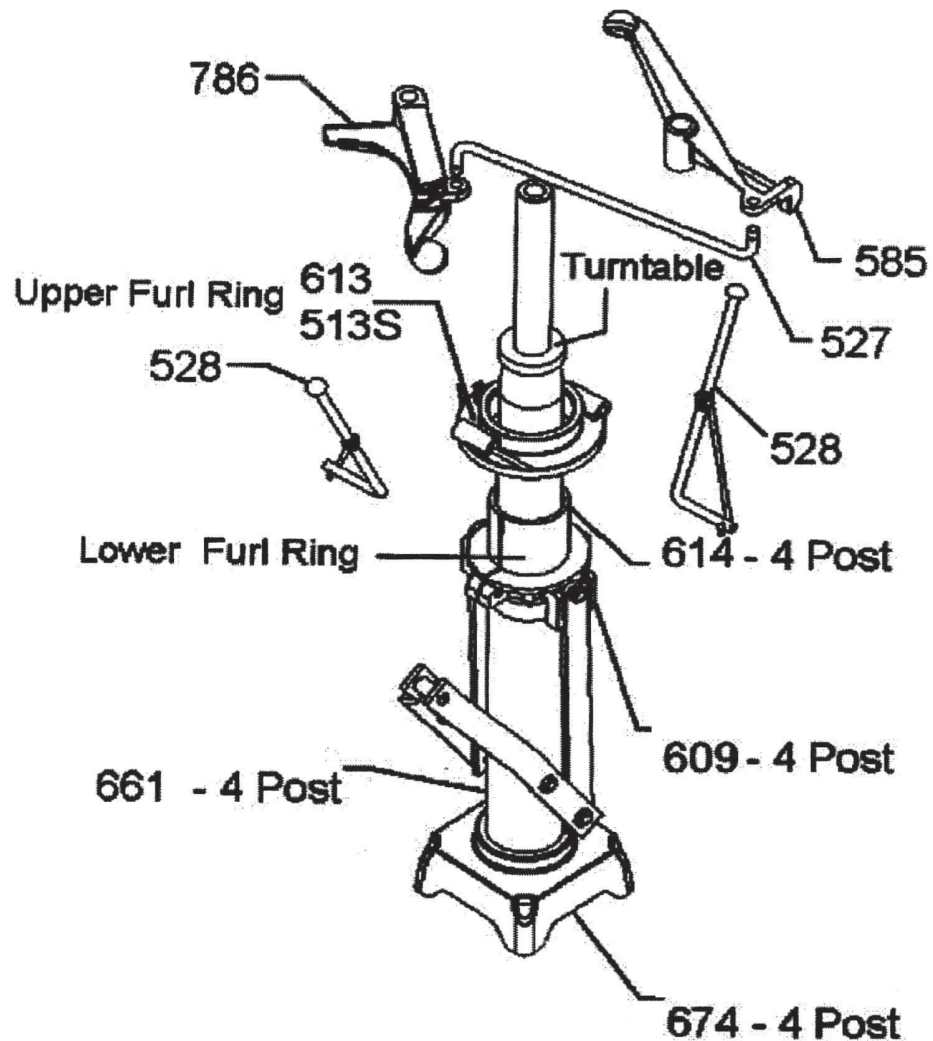

MAST PARTS

PART NO.	DESCRIPTION
513S	Upper Furl Ring
521	Turn Table Washer
528	Furl Arm
585	Tailbone Casting
609	Furl Lever Complete, 4-Post
613	Upper Furl Rings W/Arms
670	Furl Lever Complete, 3-Post

PART NO.	DESCRIPTION
675	Mast Base Only, 3-Post
661	Mast W/Base Less 570, 4-Post
663	Mast W/Base & 670, 3-Post
664	Mast W/Base & 670, 4-Post
614	Lower Furl Ring, Split
674	Mast Base Only, 4-Post

NEW 702 MODEL

AMERICAN WEST WINDMILLS

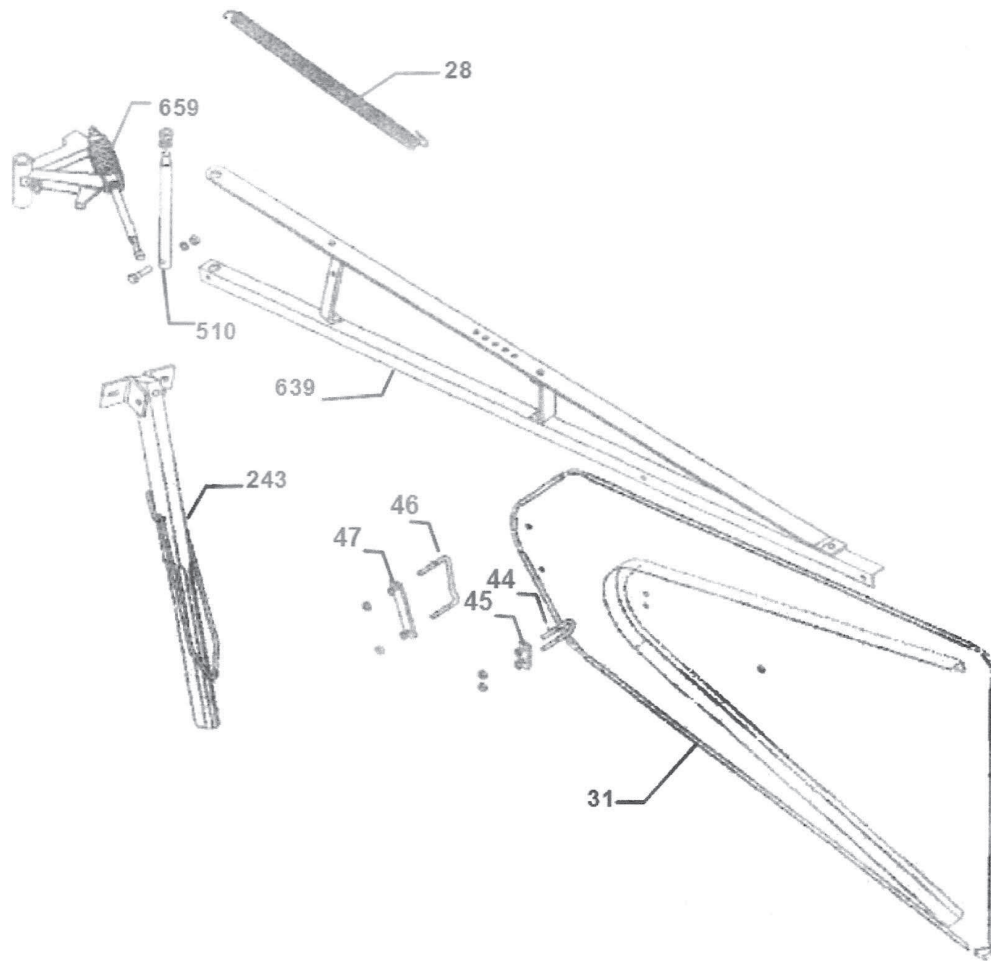

TAIL PARTS

PART NO.	DESCRIPTION
28	Vane Spring
31	Vane
44	U-Bolt, Narrow
45	Washer for 44
46	U-Bolt, Wide

PART NO.	DESCRIPTION
47	Washer for 46
243	Furl Handle, Complete
510	Pivot Bolt for Tailbone
639	Tailbone
659	Buffer Device, Complete

AMERICAN WEST WINDMILLS

In addition to its function in transmitting the reciprocal (up-and-down) stroke from the windmill downward through the tower to ground level and to the pump underground, the wooden pump rod has an additional purpose. It provides an intentionally weak link between the windmill and pump. If anything goes wrong with either the windmill or pump, this wooden rod should break before serious damage is done to either piece of equipment. [The 702 Model Windmill Its Assembly, Installation and Use, Section 3.20, p.17]

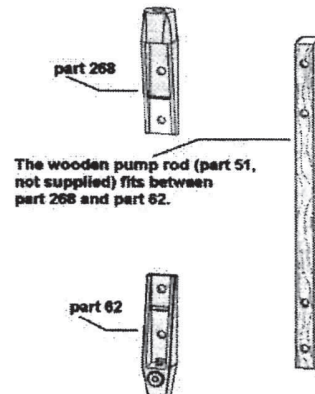

SPECIFICATIONS FOR #51 PUMP ROD

Part Number	#51 Pump Rod Dimensions*	Standard Length**
A-51	1 1/8" x 1 1/4" *	12', 14', 16' **
B-51	1 1/4" x 1 1/2" *	12', 14', 16' **
D-51	1 1/2" x 1 3/4" *	12', 14', 16' **
E-51	2" x 2 1/4" *	12', 14', 16' **
F-51	2 1/4" x 2 1/2" *	12', 14', 16' **

NOTE: This material is not supplied by the American West Windmill Co. and should be purchased locally.

Material: Grade B or Better Yellow Pine.

* Minimum Dimensions

** Standard lengths.

Cut to length required, but recommended not longer than 16'.

AMERICAN WEST WINDMILLS

OVERHAUL KIT

Product Number	Product Description	List Price
----------------	---------------------	------------

777 - Overhaul Kits

353140	X-777 Overhaul Kit	215.00
353142	A-777 Overhaul Kit	330.00
353145	B-777 Overhaul Kit	603.00
353147	D-777 Overhaul Kit	858.00
353150	E-777 Overhaul Kit	1,309.00
353152	F-777 Overhaul Kit	1,933.00

777 Overhaul Kit Includes:

- | | |
|---------------------------------|---------------------------|
| 1 - 507 Oil Ring | 1 - 720 Shaft on 705's |
| 1 - 517 Spring for Spout Washer | 1 - 744 Key for 704's |
| 1 - 522 Shaft for Guide Wheel | 1 - 708 Bearing for 704's |
| 1 - 610 Pin for Pump Rod | 1 - 730 Bearing for 720 |
| 2 - 622 Bolt w/Cotter for 686 | 1 - 729 Pin for 719 |
| 2 - 686 Pitman Arms | 1 - 520 Oil Collector |
| 2 - 704 Small Gears | 2 - 721 Pin for 705's |
| 1 - 718 Spout / Oil Collector | 1 - 752 Bearing for 720 |

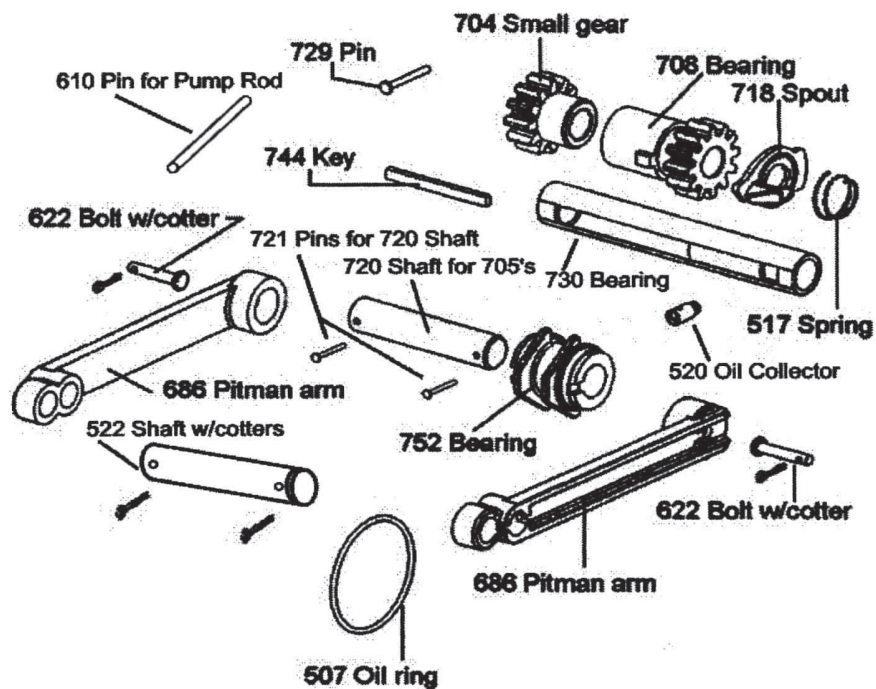

AMERICAN WEST WINDMILLS

BEARING REPAIR KIT

Product Number	Product Description	List Price
----------------	---------------------	------------

707 - Bearing Repair Kit

353120	X-707 Bearing Kit	130.00
353125	A-707 Bearing Kit	203.00
353130	B-707 Bearing Kit	365.00
353135	D-707 Bearing Kit	527.00
353137	E-707 Bearing Kit	873.00
353139	F-707 Bearing Kit	1,218.00

707 Bearing Kit Includes:

1 - 708 Bearing for 704's
 1 - 752 Bearing for 705's
 1 - 730 Bearing for 719
 2 - 721 Pin for 705's

1 - 744 Key for 704's
 2 - 686 Pitman Arms
 1 - 520 Oil Collector
 1 - 729 Pin for 719

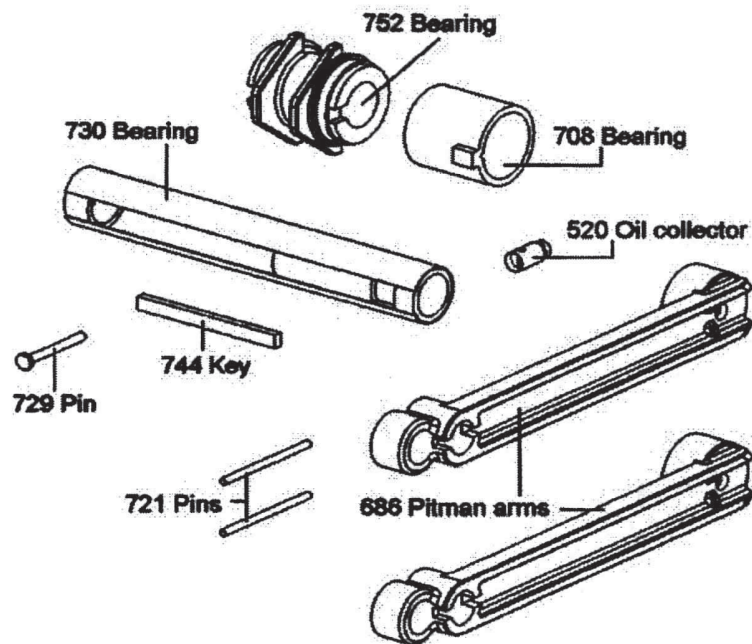

ORNAMENTAL WINDMILLS

19' American West Windmill

ACTUAL WORKING WINDMILL:
With 6' Diameter Wheel. Overall height of mill and redwood tower is 19' with base dimensions of 51/2' x 51/2'. With the Well Assembly Kit, you can use this mill to circulate water from a stock tank or similar type of water storage tank.

LIFTING HOIST:
Lifting Hoist for windmill heads makes windmill assembly and lifting the windmill to the top of the tower, fast and easy.

HOW-TO VIDEO:
Our How-To Video is included with each windmill order, providing easy, step-by-step instructions for complete windmill and tower assembly.

WELL ASSEMBLY KIT:
Well Assembly Kit includes detailed instructions and all of the elements you need to circulate water with the windmill. Kit does not include Water Tank. Well Assembly Kits are also available for Hand Pumps as well as Pitcher Pumps.



Product Number	Product Description	List Price
		call or email for prices
352540	19' American West Windmill	
352545	Lifting Hoist for Windmill Head	
352552	Windmill Well Assembly Kit	



ORNAMENTAL WINDMILLS

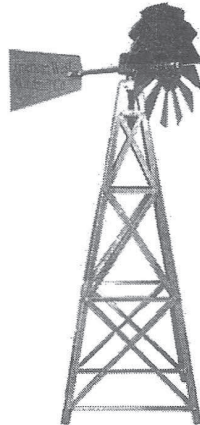

17"

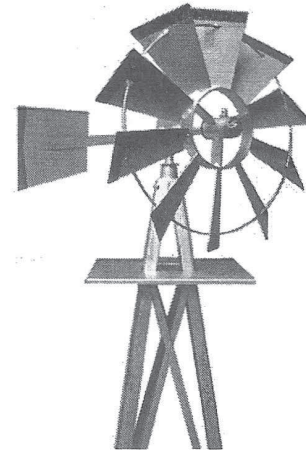

4-1/2' & 8'

Product Number	Product Description	List Price
352500	17" American West Windmill Kit	please call or email for prices
352494	4-1/2' American Windmill Kit	
352495	8' American Windmill Kit	

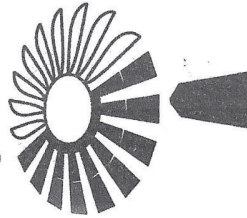

This chart represents the operating range for Aquaflex® fiber rods only. Due to the unique patented coupling design, Aquaflex® rods may be used under these loads for maximum rod life as well as increase the life and efficiency of the pumping unit.

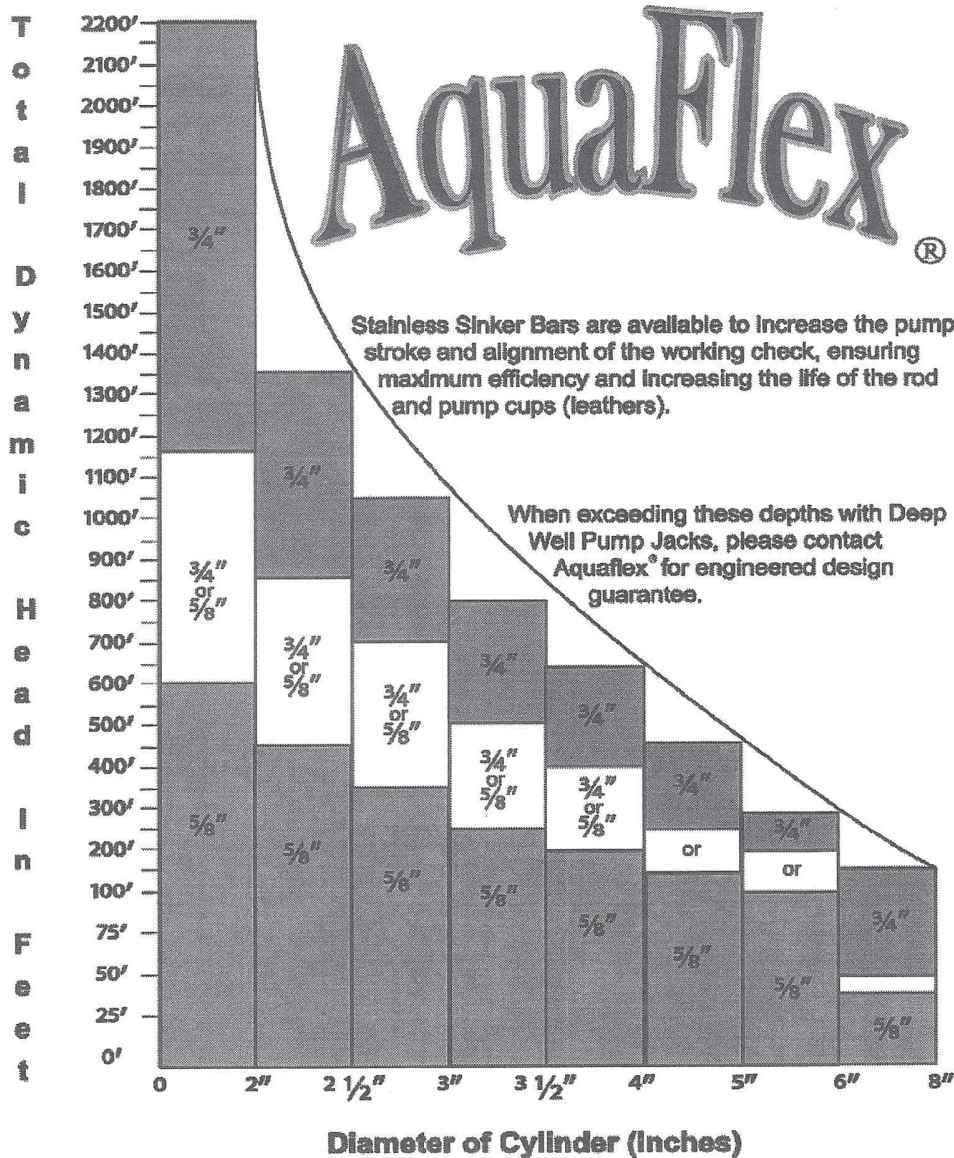

AMERICAN WEST WINDMILLS

With

5/8" AQUAFLEX

FIBERGLASS SUCKER RODS

TABLE OF PUMPING CAPACITIES AND MAXIMUM OPERATING ELEVATIONS								
Diameter of Cylinder (Inches)	Pumping Capacity (Gallons per Hour)		Pumping Elevation (Feet)					
			Wheel Diameter					
	6' Ft.	8-16' Ft.	6'	8'	10'	12'	14'	16'
LONG STROKE								
1 3/4"	105	150	152'	216'	328'	491'	702'	1170'
1 7/8"	125	180	140'	205'	304'	456'	655'	1076'
2"	130	190	111'	164'	252'	374'	538'	878'
2 1/4"	180	260	90'	129'	199'	293'	421'	690'
2 1/2"	225	325	76'	111'	164'	246'	351'	573'
2 3/4"	265	385	66'	94'	140'	211'	304'	467'
3"	320	470	55'	80'	117'	181'	257'	421'
3 1/4"	370	550	48'	68'	105'	152'	216'	357'
3 1/2"	440	640	41'	59'	89'	135'	187'	310'
3 3/4"	500	730	35'	51'	76'	117'	170'	269'
4"	570	830	32'	46'	68'	99'	146'	234'
4 1/4"	***	940	***	40'	60'	89'	129'	211'
4 1/2"	725	1050	25'	35'	54'	80'	117'	187'
4 3/4"	***	1170	***	***	48'	71'	105'	164'
5"	***	1300	20'	29'	43'	64'	94'	152'
5 3/4"	***	1700	***	***	***	47'	70'	117'
6"	***	1875	***	20'	29'	44'	64'	99'
7"	***	2550	***	***	22'	33'	48'	76'
8"	***	3300	***	***	16'	26'	36'	59'
SHORT STROKE								
1 3/4"	79	113	205'	287'	439'	655'	936'	1562'
1 7/8"	94	135	187'	275'	404'	608'	872'	1433'
2"	98	143	146'	216'	333'	497'	714'	1170'
2 1/4"	135	195	117'	170'	263'	392'	562'	918'
2 1/2"	169	244	99'	146'	216'	328'	468'	766'
2 3/4"	199	289	88'	123'	187'	281'	404'	661'
3"	240	353	74'	105'	158'	240'	345'	562'
3 1/4"	278	413	64'	90'	140'	205'	287'	474'
3 1/2"	330	480	55'	78'	117'	181'	252'	415'
3 3/4"	375	548	47'	68'	99'	158'	228'	357'
4"	428	623	42'	61'	90'	135'	193'	310'
4 1/4"	***	705	***	53'	80'	117'	170'	281'
4 1/2"	544	788	33'	47'	71'	105'	158'	252'
4 3/4"	***	878	***	***	64'	94'	140'	216'
5"	675	975	27'	39'	57'	85'	123'	205'
5 3/4"	***	1275	***	***	***	62'	94'	158'
6"	***	1406	***	27'	39'	60'	85'	135'
7"	***	1912	***	***	29'	43'	64'	99'
8"	***	2475	***	***	22'	34'	48'	78'

* Capacities are approximate and based on the mill operating in winds as shown below.

In 12 MPH winds, capacity is reduced about 20%; in 10 MPH winds, capacity is reduced about 38%.

If prevailing winds are low, use of cylinder smaller than shown will permit your mill to operate in lower winds.

AMERICAN WEST WINDMILLS

With 3/4" AQUAFLEX FIBERGLASS SUCKER RODS

TABLE OF PUMPING CAPACITIES AND MAXIMUM OPERATING ELEVATIONS								
Diameter of Cylinder (Inches)	Pumping Capacity (Gallons per Hour)		Pumping Elevation (Feet)					
			Wheel Diameter					
	6' Ft.	8-16' Ft.	6'	8'	10'	12'	14'	16'
LONG STROKE								
1 3/4"	105	150	146'	207'	314'	470'	672'	1120'
1 7/8"	125	180	134'	196'	291'	437'	627'	1030'
2"	130	190	106'	157'	241'	358'	515'	840'
2 1/4"	180	260	86'	123'	190'	280'	403'	661'
2 1/2"	225	325	73'	106'	157'	235'	336'	549'
2 3/4"	265	385	63'	90'	134'	202'	291'	476'
3"	320	470	53'	76'	112'	174'	246'	403'
3 1/4"	370	550	46'	65'	101'	146'	207'	342'
3 1/2"	440	640	39'	56'	85'	129'	179'	297'
3 3/4"	500	730	34'	49'	73'	112'	162'	258'
4"	570	830	30'	44'	65'	95'	140'	224'
4 1/4"	***	940	***	38'	57'	85'	123'	202'
4 1/2"	725	1050	24'	34'	52'	76'	112'	179'
4 3/4"	***	1170	***	***	46'	68'	101'	157'
5"	900	1300	19'	28'	41'	62'	90'	146'
5 3/4"	***	1700	***	***	***	45'	67'	112'
6"	***	1875	***	19'	28'	43'	62'	95'
7"	***	2550	***	***	21'	31'	46'	73'
8"	***	3300	***	***	16'	25'	35'	56'
SHORT STROKE								
1 3/4"	79	113	196'	274'	420'	627'	896'	1495'
1 7/8"	94	135	179'	263'	386'	582'	834'	1372'
2"	98	143	140'	207'	319'	476'	683'	1120'
2 1/4"	135	195	112'	162'	252'	375'	538'	879'
2 1/2"	169	244	95'	140'	207'	314'	448'	734'
2 3/4"	199	289	84'	118'	179'	269'	386'	633'
3"	240	353	71'	101'	151'	230'	330'	538'
3 1/4"	278	413	62'	86'	134'	196'	274'	454'
3 1/2"	330	480	53'	75'	112'	174'	241'	398'
3 3/4"	375	548	45'	65'	95'	151'	218'	342'
4"	428	623	40'	58'	86'	129'	185'	297'
4 1/4"	***	705	***	50'	76'	112'	162'	269'
4 1/2"	544	788	31'	45'	68'	101'	151'	241'
4 3/4"	***	878	***	***	62'	90'	134'	207'
5"	675	975	26'	37'	55'	82'	118'	196'
5 3/4"	***	1275	***	***	***	59'	90'	151'
6"	***	1406	***	26'	37'	57'	82'	129'
7"	***	1912	***	***	28'	41'	62	95'
8"	***	2475	***	***	21'	32'	46'	75'

* Capacities are approximate and based on the mill operating in winds as shown below.

In 12 MPH winds, capacity is reduced about 20%; in 10 MPH winds, capacity is reduced about 38%.

If prevailing winds are low, use of cylinder smaller than shown will permit your mill to operate in lower winds.

AMERICAN WEST WINDMILLS

With

3/4" - #2 STEEL**HOLLOW "AIRTIGHT" SUCKER RODS**

TABLE OF PUMPING CAPACITIES AND MAXIMUM OPERATING ELEVATIONS								
Diameter of Cylinder (Inches)	Pumping Capacity (Gallons per Hour)		Pumping Elevation (Feet)					
			Wheel Diameter					
	6' Ft.	8-16' Ft.	6'	8'	10'	12'	14'	16'
LONG STROKE								
1 3/4"	105	150	94'	133'	202'	302'	432'	720'
1 7/8"	125	180	86'	126'	187'	281'	403'	662'
2"	130	190	68'	101'	155'	230'	331'	540'
2 1/4"	180	260	55'	79'	122'	180'	259'	425'
2 1/2"	225	325	47'	68'	101'	151'	216'	353'
2 3/4"	265	385	40'	58'	86'	130'	187'	306'
3"	320	470	34'	49'	72'	112'	158'	259'
3 1/4"	370	550	30'	42'	65'	94'	133'	220'
3 1/2"	440	640	25'	36'	55'	83'	115'	191'
3 3/4"	500	730	22'	32'	47'	72'	104'	166'
4"	570	830	19'	28'	42'	61'	90'	144'
4 1/4"	***	940	***	24'	37'	55'	79'	130'
4 1/2"	725	1050	15'	22'	33'	49'	72'	115'
4 3/4"	***	1170	***	***	30'	44'	65'	101'
5"	900	1300	12'	18'	27'	40'	58'	94'
5 3/4"	***	1700	***	***	***	29'	43'	72'
6"	***	1875	***	12'	18'	27'	40'	61'
7"	***	2550	***	***	14'	20'	30'	47'
8"	***	3300	***	***	10'	16'	22'	36'
SHORT STROKE								
1 3/4"	79	113	126'	176'	270'	403'	576'	961'
1 7/8"	94	135	115'	169'	248'	374'	536'	882'
2"	98	143	90'	133'	205'	306'	439'	720'
2 1/4"	135	195	72'	104'	162'	241'	346'	565'
2 1/2"	169	244	61'	90'	133'	202'	288'	472'
2 3/4"	199	289	54'	76'	115'	173'	248'	407'
3"	240	353	45'	65'	97'	148'	212'	346'
3 1/4"	278	413	40'	55'	86'	126'	176'	292'
3 1/2"	330	480	34'	48'	72'	112'	155'	256'
3 3/4"	375	548	29'	42'	61'	97'	140'	220'
4"	428	623	26'	37'	55'	83'	119'	191'
4 1/4"	***	705	***	32'	49'	72'	104'	173'
4 1/2"	544	788	20'	29'	44'	65'	97'	155'
4 3/4"	***	878	***	***	40'	58'	86'	133'
5"	675	975	17'	24'	35'	53'	76'	126'
5 3/4"	***	1275	***	***	***	38'	58'	97'
6"	***	1406	***	17'	24'	37'	53'	83'
7"	***	1912	***	***	18'	27'	40'	61'
8"	***	2475	***	***	14'	21'	30'	48'

* Capacities are approximate and based on the mill operating in winds as shown below.

In 12 MPH winds, capacity is reduced about 20%; in 10 MPH winds, capacity is reduced about 38%. If prevailing winds are low, use of cylinder smaller than shown will permit your mill to operate in lower winds.

AMERICAN WEST WINDMILLS

With

1 1/8", 1 3/8", WOOD ROD
1/2" #1 STEEL "AIRTIGHT" ROD
7/16" SOLID STEEL ROD

TABLE OF PUMPING CAPACITIES AND MAXIMUM OPERATING ELEVATIONS								
Diameter of Cylinder (Inches)	Pumping Capacity (Gallons per Hour)		Pumping Elevation (Feet)					
			Wheel Diameter					
	6' Ft.	8-16' Ft.	6'	8'	10'	12'	14'	16'
LONG STROKE								
1 3/4"	105	150	130'	185'	280'	420'	600'	1000'
1 7/8"	125	180	120'	175'	260'	390'	560'	920'
2"	130	190	95'	140'	215'	320'	460'	750'
2 1/4"	180	260	77'	110'	170'	250'	360'	590'
2 1/2"	225	325	65'	95'	140'	210'	300'	490'
2 3/4"	265	385	56'	80'	120'	180'	260'	425'
3"	320	470	47'	68'	100'	155'	220'	360'
3 1/4"	370	550	41'	58'	90'	130'	185'	305'
3 1/2"	440	640	35'	50'	76'	115'	160'	265'
3 3/4"	500	730	30'	44'	65'	100'	145'	230'
4"	570	830	27'	39'	58'	85'	125'	200'
4 1/4"	***	940	***	34'	51'	76'	110'	180'
4 1/2"	725	1050	21'	30'	46'	68'	100'	160'
4 3/4"	***	1170	***	***	41'	61'	90'	140'
5"	900	1300	17'	25'	37'	55'	80'	130'
5 3/4"	***	1700	***	***	***	40'	60'	100'
6"	***	1875	***	17'	25'	38'	55'	85'
7"	***	2550	***	***	19'	28'	41'	65'
8"	***	3300	***	***	14'	22'	31'	50'
SHORT STROKE								
1 3/4"	79	113	175'	245'	375'	560'	800'	1335'
1 7/8"	94	135	160'	235'	345'	520'	745'	1225'
2"	98	143	125'	185'	285'	425'	610'	1000'
2 1/4"	135	195	100'	145'	225'	335'	480'	785'
2 1/2"	169	244	85'	125'	185'	280'	400'	655'
2 3/4"	199	289	75'	105'	160'	240'	345'	565'
3"	240	353	63'	90'	135'	205'	295'	480'
3 1/4"	278	413	55'	77'	120'	175'	245'	405'
3 1/2"	330	480	47'	67'	100'	155'	215'	355'
3 3/4"	375	548	40'	58'	85'	135'	195'	305'
4"	428	623	36'	52'	77'	115'	165'	265'
4 1/4"	***	705	***	45'	68'	100'	145'	240'
4 1/2"	544	788	28'	40'	61'	90'	135'	215'
4 3/4"	***	878	***	***	55'	80'	120'	185'
5"	675	975	23'	33'	49'	73'	105'	175'
5 3/4"	***	1275	***	***	***	53'	80'	135'
6"	***	1406	***	23'	33'	51'	73'	115'
7"	***	1912	***	***	25'	37'	55'	85'
8"	***	2475	***	***	19'	29'	41'	67'

* Capacities are approximate and based on the mill operating in winds as shown below.

In 12 MPH winds, capacity is reduced about 20%; in 10 MPH winds, capacity is reduced about 38%.

If prevailing winds are low, use of cylinder smaller than shown will permit your mill to operate in lower winds.

AMERICAN WEST WINDMILLS

ELEVATION PUMPING ADJUSTMENTS

In cases of extremely shallow pump settings with extremely high elevations above surface, you may be able to increase cylinder size of pump. Incases of extremely deep submergence of pump below pumping level, you may need to decrease cylinder size of pump.

Ask your American West Windmill Dealer to help you when operating under these conditions.

Note: Adjustment to Pumping Elevation on TABLE OF PUMPING CAPACITIES chart.

Per 100 feet - Surface Elevation Plus 33 Ft.

Per 100 feet - Submergence Minus 33 Ft.

(Be sure to adjust 33 Ft. based on rod chart above.)

OVERLOAD! - When operating an American West Windmill under overload conditions, it may cause fatigue and failure of wheel parts, excessive wear of gears and bearings and decrease the production and life of the windmill.

SINKER BAR (use with rod strings that are non-ridged or that are lighter than 43 lbs. per 100 Ft.)
The use of a steel shaft (1-3/16" Dia.) to tie sucker rod strings to the working check of the pump, may increase the pumping capacity up to 30% by keeping tension on the rod and helping insure full stroke of the pump. A sinker bar that has been precision machined will also help insure proper alignment of the working check (plunger) in the cylinder, thus increasing the efficiency and expected life of the pump.

Calculation for Sinker Bar Sizing:

1 lb. Per 23' (10 lbs. Minimum)

Sinker Bar Diameter	Approx. Weight Lbs. / Inch
5/8"	0.0869
3/4"	0.1252
7/8"	0.1703
1"	0.2225
1 1/16"	0.2512
1 3/16"	0.3138

PONY ROD: Usually a short rod with precision aligned rod couplings used for alignment of the working check (plunger) in the cylinder, thus increasing the efficiency and expected life of the pump cups (leathers).



"AQUAFLEX" FIBERGLASS SUCKER ROD & ACCESSORIES

AQUAFLEX FIBERGLASS SUCKER ROD - WITH (2) ROD GUIDES

*All materials meet FDA approval for potable water applications.

5 YEAR GUARANTEE - against failure due to corrosion, coupling separation from rod body, faulty material or workmanship.

COUPLING - Patented rod socket design, made of high quality 1144 stressed proof steel, insures unsurpassed strength and cycle life. High quality plating provides superior corrosion resistance.

Machined flats to accommodate standard break out wrenches and elevators.

ROD BODY - Solid round fiberglass construction to provide strength and light weight to increase pumping efficiency.

ROD GUIDES - Patented design and assembly. Made of 10% silicon glass filled polycarbonate for wearability.

Two guides per rod provides protection against rod body, coupling and tubing wear. Low friction design insures smooth operation and increased efficiency.

Product Number	Product Description	List Price
----------------	---------------------	------------

AQUAFLEX FIBERGLASS SUCKER ROD - WITH (2) ROD GUIDES

370315	5/8" x 15.75' AquaFlex Sucker Rod	
370320	5/8" x 20' AquaFlex Sucker Rod	
370325	5/8" x 21' AquaFlex Sucker Rod	

370330	3/4" x 15.75' AquaFlex Sucker Rod	
370335	3/4" x 21' AquaFlex Sucker Rod	

AQUAFLEX FIBERGLASS SUCKER ROD - WITHOUT ROD GUIDES

370326	5/8" x 21' AquaFlex Sucker Rod - Less Guides	
370336	3/4" x 21' AquaFlex Sucker Rod - Less Guides	

AQUAFLEX ROD COUPLING KITS

370405	5/8" AquaFlex Male Coupling Kit	
370410	5/8" AquaFlex Female Coupling Kit	

370415	3/4" AquaFlex Male Coupling Kit	
370420	3/4" AquaFlex Female Coupling Kit	

"AQUALITE" FIBERGLASS SUCKER ROD - WITHOUT ROD GUIDES

1 YEAR GUARANTEE - Against rod failure due to corrosion, rod body separation from coupling, faulty material or workmanship.

COUPLING - 7/8" hex steel, high quality plating and specially designed rod socket provide strength and superior corrosion resistance. Packaged 5 rods per bundle.

AQUALITE FIBERGLASS SUCKER ROD - WITHOUT ROD GUIDES

370327	5/8" x 21' AquaLite Sucker Rod - Less Guides	
--------	--	--

AQUALITE ROD COUPLING KITS

370435	5/8" AquaLite Male Coupling Kit	
370440	5/8" AquaLite Female Coupling Kit	

NOTE: Epoxy used in Coupling Kits is time dated and should be stored in a cool, dark climate for long term storage.

please call or email for prices



AQUAFLEX FIBERGLASS SUCKER ROD & ACCESSORIES

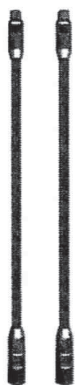

Product Number	Product Description	List Price
----------------	---------------------	------------

AQUAFLEX PONY RODS

370345	5/8" x 2' Pony Rod	please call or email for prices
370350	5/8" x 3' Pony Rod	
370355	5/8" x 5' Pony Rod	
370360	5/8" x 7' Pony Rod	

370365	3/4" x 2' Pony Rod	please call or email for prices
370370	3/4" x 3' Pony Rod	
370375	3/4" x 5' Pony Rod	
370380	3/4" x 7' Pony Rod	

1 3/16" SINKER BAR 416 STAINLESS STEEL

Used to weight pump rod to insure proper alignment of plunger in pump barrel. This bar also helps insure maximum stroke at bottom of the well, increasing the overall efficiency of the pump system.

370530	31" - 5/8"M x 5/8"F 10lbs.	please call or email for prices
370540	31" - 7/8"M x 5/8"F 10lbs.	
370550	31" - 5/8"M x 7/8"F 10lbs.	
370560	31" - 7/8"M x 7/8"F 10lbs.	

370535	93" - 5/8"M x 5/8"F 30lbs.	please call or email for prices
370545	93" - 7/8"M x 5/8"F 30lbs.	
370555	93" - 5/8"M x 7/8"F 30lbs.	
370565	93" - 7/8"M x 7/8"F 30lbs.	



ROD GUIDES - For Fiberglass Rods

370505	5/8" x 2" Rod Guide	please call or email for prices
370507	5/8" x 2-1/2" Rod Guide	
370510	3/4" x 2" Rod Guide	
370512	3/4" x 2-1/2" Rod Guide	

ROD COUPLING ADAPTERS

371305	7/16"F x 7/16"M	2.50	371310	3/8"F x 3/8"F	please call or email for prices
371306	7/16"M x 5/8"F **	15.00	371280	1/2"MP x 7/16"FR	
371307	7/16"F x 5/8"F **	15.00	371285	1/2"MP x 5/8"FR	
371308	5/8"M x 7/16"F **	15.00	371290	1/2"FP x 7/16"MR	
371315	5/8"M x 7/8"F **	15.00	371295	1/2"FP x 5/8"MR	
371325	7/8"M x 5/8"F **	15.00			



NOTE: Adapters with ** are Stainless Steel.



WOOD ROD & ACCESSORIES

Product Number	Product Description	List Price
----------------	---------------------	------------

ASH WOOD ROD (WHITE ROD)

370005	1-1/8" With Galvanized Couplings
370010	1-1/8" With Black Couplings
370015	1-3/8" With Galvanized Couplings
370020	1-3/8" With Black Couplings

WOOD ROD ENDS - COUPLINGS

370105	1-1/8" Female Galvanized Coupling
370110	1-1/8" Male Galvanized Coupling

370125	1-1/8" Female Black Coupling
370130	1-1/8" Male Black Coupling

370115	1-3/8" Female Galvanized Coupling
370120	1-3/8" Male Galvanized Coupling

370135	1-3/8" Female Black Coupling
370140	1-3/8" Male Black Coupling

WOOD ROD RIVETS

370205	3/16" x 1-1/2" Copper Rivet 1 lb.
370210	1/4" x 1-7/8" Copper Rivet 1 lb.

370215	3/16" x 1-1/2" Steel Rivet 1 lb.
370220	1/4" x 1-7/8" Steel Rivet 1 lb.

STEEL PUMP ROD

690710	7/16" x 18' Galvanized Rod - Threaded & Coupled
690711	7/16" x 21' Galvanized Rod - Threaded & Coupled

please call
or email
for prices



**PLEASE NOTE THAT WOOD ROD IS SOLD
IN COMPLETE BUNDLES ONLY.**

1-1/8" ROD = 9 RODS PER BUNDLE

1-3/8" ROD = 6 RODS PER BUNDLE



LEATHERS - NEO CUPS

Product Number	Product Description	List Price
----------------	---------------------	------------

#95 / 707 GRAPHITE TREATED LEATHERS



371470	1 3/8" x 5/8"
371472	1 13/16" x 1 3/16"
371475	1 7/8" x 1 1/4" (Midland)
371477	1 7/8" x 1 5/16" (Clayton Mark)
371480	2" x 1 5/16"
371485	2 1/4" x 1 1/2"
371487	2 1/2" x 1 5/8"
371490	2 3/4" x 1 7/8"
371492	3" x 2"

please call
or email
for prices

#94 / 711 SOFT LEATHERS

371500	1 7/8" x 1 1/4" (Midland)
371502	1 7/8" x 1 5/16" (Clayton Mark)
371503	2" x 1 5/16"
371505	2 1/4" x 1 1/2"
371507	2 1/2" x 1 5/8"
371510	2 3/4" x 1 7/8"
371512	3" x 2"

"TOWNER" NEOPRENE CUPS



371040	1 1/4" x 5/8" Neo-Cup
371045	1 3/8" x 5/8" Neo-Cup
371050	1 7/8" x 1 1/4" Neo-Cup (Midland)
371049	1 7/8" x 1 5/16" Neo-Cup (Clayton Mark)
371051	2" x 1 5/16" Neo-Cup
371052	2" x 1/2" Neo-Cup
371055	2 1/4" x 1 1/2" Neo-Cup
371057	2 1/2" x 1 5/8" Neo-Cup
371060	2 3/4" x 1 7/8" Neo-Cup
371065	3" x 2" Neo-Cup

GRAPHITE PACKING

371260	1/4" Graphite Packing 1 lb. Box
371255	3/8" Graphite Packing 1 lb. Box

PLEASE NOTE THAT LEATHERS (CUPS)
ARE SOLD IN CARTON QUANTITY ONLY.

LEATHERS = 12 PER CARTON
TOWNER NEOPRENE CUPS = 6 PER CARTON



WELL ACCESSORIES

Product Number	Product Description	List Price
----------------	---------------------	------------

PVC SUCTION STRAINER (18" x .020" Screen/Cut to Length)

371185	1-1/4" PVC Suction Screen	
371190	1-1/2" PVC Suction Screen	
371165	2" PVC Suction Screen	

WELL POINTS (60 Gauze)

371155	1-1/4" x 24" Well Point	please call or email for prices
371160	1-1/4" x 30" Well Point	
371165	1-1/4" x 36" Well Point	
371175	2" x 30" Well Point	

GALVANIZED TANK NIPPLES & LOCK NUT

690007	3/4" X 6" Galv. Tank Nipple	please call or email for prices
690008	1" X 6" Galv. Tank Nipple	
690009	1-1/4" X 6" Galv. Tank Nipple	
690010	1-1/2" X 6" Galv. Tank Nipple	
690011	2" X 6" Galv. Tank Nipple	
690013	3/4" Galv. Lock Nut	
690014	1" Galv. Lock Nut	
690015	1-1/4" Galv. Lock Nut	
690016	1-1/2" Galv. Lock Nut	
690017	2" Galv. Lock Nut	

HAND PUMPS

HAND LIFT & HAND FORCE PUMPS

349100	50-ASP-6 Hand / Windmill Force Pump	please call or email for prices
349105	190-SP-6 Hand Lift Pump	
349110	PHB Force Pitcher Pump	
352555	HPP10 Pitcher Pump	



50-ASP-6

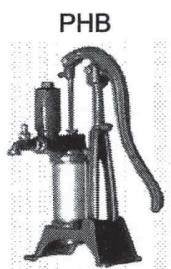

PHB



HPP10



190-SP-6



MIDLAND WELL CYLINDERS & STUFFING BOXES

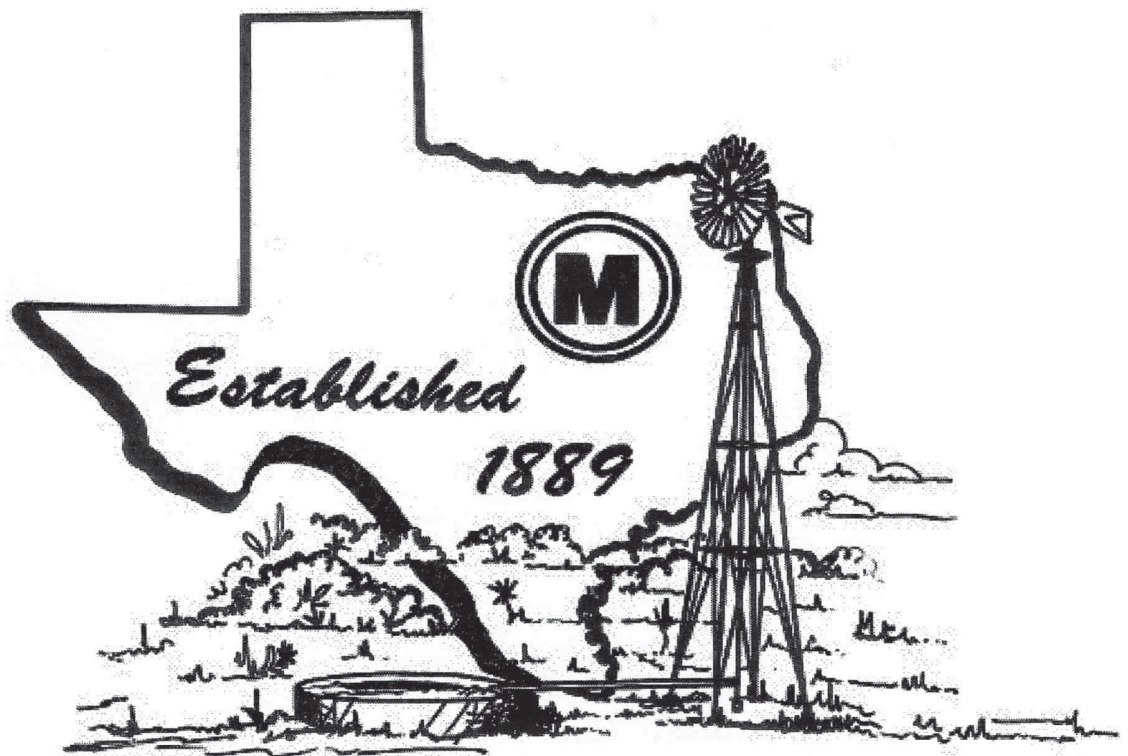



Product Number	Product Description	List Price
----------------	---------------------	------------

1 7/8" MIDLAND 449 11 GAUGE CYLINDERS & PARTS

M02305	1 7/8" X 24" 449B 3 Leather - Ball 11 Gauge Cylinder	
M02306	1 7/8" x 30" 449B 3 Leather - Ball 11 Gauge Cylinder	
M02307	1 7/8" x 36" 449B 3 Leather - Ball 11 Gauge Cylinder	
M02308	1 7/8" x 42" 449B 3 Leather - Ball 11 Gauge Cylinder	

M02505	1 7/8" x 24" 11 Gauge Barrel Less Caps	Please call or email for prices
M02506	1 7/8" x 30" 11 Gauge Barrel Less Caps	
M02507	1 7/8" x 36" 11 Gauge Barrel Less Caps	
M02508	1 7/8" x 42" 11 Gauge Barrel Less Caps	

M03222	1 7/8 11G Top Cap	
M03223	1 7/8 11G Bottom Cap	
M03228	1 7/8 3 Leather Ball Plunger	
M03229	1 7/8 4 Leather Ball Plunger	
M03231	1 7/8 Ball Check	
M03226	1 7/8 3 Leather Spool Plunger	
M03227	1 7/8 4 Leather Spool Plunger	
M03230	1 7/8 Spool Check	



2 1/4" MIDLAND 449 11 GAUGE CYLINDERS & PARTS

M02309	2 1/4" X 24" 449B 3 Leather - Ball 11 Gauge Cylinder	
M02310	2 1/4" x 30" 449B 3 Leather - Ball 11 Gauge Cylinder	
M02311	2 1/4" x 36" 449B 3 Leather - Ball 11 Gauge Cylinder	
M02312	2 1/4" x 42" 449B 3 Leather - Ball 11 Gauge Cylinder	

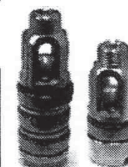

M02509	2 1/4" x 24" 11 Gauge Barrel Less Caps	Please call or email for prices
M02510	2 1/4" x 30" 11 Gauge Barrel Less Caps	
M02511	2 1/4" x 36" 11 Gauge Barrel Less Caps	
M02512	2 1/4" x 42" 11 Gauge Barrel Less Caps	



M03322	2 1/4 11G Top Cap	Please call or email for prices
M03323	2 1/4 11G Bottom Cap	
M03328	2 1/4 3 Leather Ball Plunger	
M03329	2 1/4 4 Leather Ball Plunger	
M03331	2 1/4 Ball Check	
M03326	2 1/4 3 Leather Spool Plunger	
M03327	2 1/4 4 Leather Spool Plunger	
M03330	2 1/4 Spool Check	

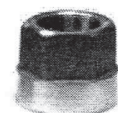



Product Number	Product Description	List Price
----------------	---------------------	------------

2 3/4" MIDLAND 449 11 GAUGE CYLINDERS & PARTS

M02313	2 3/4" X 24" 449B 3 Leather - Ball 11 Gauge Cylinder
M02314	2 3/4" x 30" 449B 3 Leather - Ball 11 Gauge Cylinder
M02315	2 3/4" x 36" 449B 3 Leather - Ball 11 Gauge Cylinder
M02316	2 3/4" x 42" 449B 3 Leather - Ball 11 Gauge Cylinder

M02513	2 3/4" x 24" 11 Gauge Barrel Less Caps
M02514	2 3/4" x 30" 11 Gauge Barrel Less Caps
M02515	2 3/4" x 36" 11 Gauge Barrel Less Caps
M02516	2 3/4" x 42" 11 Gauge Barrel Less Caps

M03422	2 3/4 11G Top Cap
M03423	2 3/4 11G Bottom Cap
M03428	2 3/4 3 Leather Ball Plunger
M03429	2 3/4 4 Leather Ball Plunger
M03431	2 3/4 Ball Check
M03426	2 3/4 3 Leather Spool Plunger
M03427	2 3/4 4 Leather Spool Plunger
M03430	2 3/4 Spool Check

please
call
or
email
for prices

MIDLAND 449 ALL BRASS EASY PULL CYLINDERS

M04101	1 7/8 X 24 All Brass Easy Pull Cylinder
M04102	1 7/8 X 30 All Brass Easy Pull Cylinder
M04103	1 7/8 X 36 All Brass Easy Pull Cylinder
M04104	1 7/8 X 42 All Brass Easy Pull Cylinder
M04105	1 7/8 X 48 All Brass Easy Pull Cylinder

M04106	2 1/4 X 24 All Brass Easy Pull Cylinder
M04107	2 1/4 X 30 All Brass Easy Pull Cylinder
M04108	2 1/4 X 36 All Brass Easy Pull Cylinder
M04109	2 1/4 X 42 All Brass Easy Pull Cylinder
M04110	2 1/4 X 48 All Brass Easy Pull Cylinder

please
call
or
email
for prices

M04111	2 3/4 X 24 All Brass Easy Pull Cylinder
M04112	2 3/4 X 30 All Brass Easy Pull Cylinder
M04113	2 3/4 X 36 All Brass Easy Pull Cylinder
M04114	2 3/4 X 42 All Brass Easy Pull Cylinder
M04115	2 3/4 X 48 All Brass Easy Pull Cylinder





Product Number	Product Description	List Price
----------------	---------------------	------------

MIDLAND 852B HEAVY DUTY BRASS CYLINDERS

M80302	1 7/8 x 24 852B 3 Leather - Heavy Duty Brass Cylinder
M80303	1 7/8 x 30 852B 3 Leather - Heavy Duty Brass Cylinder
M80304	1 7/8 x 36 852B 3 Leather - Heavy Duty Brass Cylinder
M80305	1 7/8 x 42 852B 3 Leather - Heavy Duty Brass Cylinder

M80308	2 1/4 x 24 852B 3 Leather - Heavy Duty Brass Cylinder
M80309	2 1/4 x 30 852B 3 Leather - Heavy Duty Brass Cylinder
M80310	2 1/4 x 36 852B 3 Leather - Heavy Duty Brass Cylinder
M80311	2 1/4 x 42 852B 3 Leather - Heavy Duty Brass Cylinder

M80313	2 3/4 x 24 852B 3 Leather - Heavy Duty Brass Cylinder
M80314	2 3/4 x 30 852B 3 Leather - Heavy Duty Brass Cylinder
M80315	2 3/4 x 36 852B 3 Leather - Heavy Duty Brass Cylinder
M80316	2 3/4 x 42 852B 3 Leather - Heavy Duty Brass Cylinder

please
call
or
email
for prices

MIDLAND 852 REPAIR BARRELS WITH CAPS

M80602	1 7/8 x 24 852 Heavy Duty Brass Barrel With Caps
M80603	1 7/8 x 30 852 Heavy Duty Brass Barrel With Caps
M80604	1 7/8 x 36 852 Heavy Duty Brass Barrel With Caps
M80605	1 7/8 x 42 852 Heavy Duty Brass Barrel With Caps
M80608	2 1/4 x 24 852 Heavy Duty Brass Barrel With Caps
M80609	2 1/4 x 30 852 Heavy Duty Brass Barrel With Caps
M80610	2 1/4 x 36 852 Heavy Duty Brass Barrel With Caps
M80611	2 1/4 x 42 852 Heavy Duty Brass Barrel With Caps
M80613	2 3/4 x 24 852 Heavy Duty Brass Barrel With Caps
M80614	2 3/4 x 30 852 Heavy Duty Brass Barrel With Caps
M80615	2 3/4 x 36 852 Heavy Duty Brass Barrel With Caps
M80616	2 3/4 x 42 852 Heavy Duty Brass Barrel With Caps



Product Number	Product Description	List Price
----------------	---------------------	------------

#442 ALL BRASS SHALLOW WELL CYLINDERS

M06102	2 x 14 #442 SW Cylinder 1 1/4" Discharge
M06103	2 x 16 #442 SW Cylinder 1 1/4" Discharge
M06104	2 x 18 #442 SW Cylinder 1 1/4" Discharge
M06108	2 1/4 x 16 #442 SW Cylinder 1 1/4" Discharge
M06109	2 1/4 x 18 #442 SW Cylinder 1 1/4" Discharge
M06110	2 1/4 x 20 #442 SW Cylinder 1 1/4" Discharge
M16122	3 x 14 #442 SW Cylinder 1 1/4" Discharge
M16123	3 x 16 #442 SW Cylinder 1 1/4" Discharge
M16124	3 x 18 #442 SW Cylinder 1 1/4" Discharge

please
call
or
email
for prices

#444 ALL BRASS SHALLOW WELL CYLINDERS

M06202	2 x 14 #444 SW Cylinder 1 1/4" Discharge
M06203	2 x 16 #444 SW Cylinder 1 1/4" Discharge
M06204	2 x 18 #444 SW Cylinder 1 1/4" Discharge
M06208	2 1/4 x 16 #444 SW Cylinder 1 1/4" Discharge
M06209	2 1/4 x 18 #444 SW Cylinder 1 1/4" Discharge
M06210	2 1/4 x 20 #444 SW Cylinder 1 1/4" Discharge
M06213	2 1/2 x 16 #444 SW Cylinder 1 1/4" Discharge
M06214	2 1/2 x 18 #444 SW Cylinder 1 1/4" Discharge
M06215	2 1/2 x 20 #444 SW Cylinder 1 1/4" Discharge
M06222	3 x 14 #444 SW Cylinder 1 1/4" Discharge
M06223	3 x 16 #444 SW Cylinder 1 1/4" Discharge
M06224	3 x 18 #444 SW Cylinder 1 1/4" Discharge

MIDLAND WINDMILL STUFFING BOXES

M20105	1 1/4" Stuffing Box 5/8" Stainless Steel Rod Packed
M20305	2" Stuffing Box 5/8" Stainless Steel Rod Packed
M10405	2" HS Stuffing Box 7/8" Stainless Steel Rod Packed
M20111	2" Spring Loaded Stuffing Box 5/8" Stainless Steel Rod
M10116	V-Rings for S.L. Stuffing Box

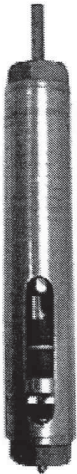



Q-33

#449 ALL BRASS DEEP WELL CYLINDERS WITH SPOOL (#449) OR BALL (#449B) VALVES

These all brass open top cylinders are made with seamless 11 guage brass tubing.

You have your choice of Solid Bronze Ball Valves or Spool Poppet Type Valves with either 3 or 4 leathers on the plunger.

Plungers are tapped so they can screw on to the check valve for easy removal. Longer strokes and larger sizes are available upon request.

11 GAUGE HEAVY CYLINDERS

Inside Diameter	Length Tubing	Stroke	#449 Spool		#449B Ball		Approx Weight Each Pounds	Repair Barrel Without Caps	Approx Weight Each Pounds
			Three Leather Spool Plunger	Four Leather Spool Plunger	Three Leather Ball Plunger	Four Leather Ball Plunger			
1 3/8	24	17	248.90	*****	251.00	*****	8	84.20	4
1 7/8	18	8	261.90	291.40	264.50	294.00	14	91.30	4
1 7/8	24	14	273.50	302.90	276.10	305.60	15	102.90	5.5
1 7/8	30	20	285.10	314.50	287.70	317.20	16	115.60	7
1 7/8	36	26	296.60	326.10	299.30	328.80	17	126.10	8
1 7/8	42	32	308.20	337.70	310.90	340.30	18	137.70	9
2 1/4	24	13	360.30	396.10	373.20	409.00	17	128.90	6.5
2 1/4	30	19	377.10	412.90	390.10	425.90	18	145.80	8
2 1/4	36	26	394.00	429.70	406.90	442.70	20	162.60	9.5
2 1/4	42	31	410.80	446.60	423.80	459.60	21	179.50	11
2 3/4	24	12	530.80	572.90	560.10	602.30	23	175.90	8
2 3/4	30	18	548.70	590.80	578.00	620.10	25	193.70	10
2 3/4	36	24	566.60	608.70	595.90	638.00	27	211.60	12
2 3/4	42	30	584.50	626.60	613.80	655.90	29	229.50	14
2 3/4	48	36	602.40	644.50	631.70	673.80	31	247.40	16
3 3/4	36	20	899.40	952.10	998.70	1,051.40	47	261.30	17
3 3/4	42	26	924.70	977.30	1,024.00	1,076.60	50	286.50	19.5
3 3/4	48	32	950.00	1,002.60	1,049.30	1,101.90	53	311.80	22
3 3/4	54	38	972.10	1,024.70	1,074.50	1,127.20	56	337.10	25
3 3/4	60	44	1,000.50	1,053.10	1,104.00	1,156.60	59	362.30	28





Midland Mfg. Co.

#852 BRASS LINED DEEP WELL CYLINDERS WITH SPOOL (#852) OR BALL (#852B) VALVES

The #852 cylinders are heavy duty deep well cylinders made with a seamless heavy duty brass tube. These open top cylinders are available with either Bronze Ball Valves or Spool Poppet Valves with either 3 or 4 leathers on the plunger. Plungers are tapped so they can screw onto the check valve for easy removal. Longer strokes and some larger sizes available upon request.

#852 Heavy Duty Brass Deep Well Cylinder

Inside Diameter	Length Tubing	Stroke	#852 Spool		#852B Ball		Approx Weight Each Pounds	#852 Repair Barrel	Approx Weight Each Pounds
			Three Leather Spool Plunger	Four Leather Spool Plunger	Three Leather Ball Plunger	Four Leather Ball Plunger			
1 7/8	18	6					12		8
1 7/8	24	12					15		11
1 7/8	30	18					17		14
1 7/8	36	24					20		17
1 7/8	42	30					23		19
1 7/8	48	36					26		22
2 1/4	18	6					16		11
2 1/4	24	12					20		15
2 1/4	30	18					24		19
2 1/4	36	24					28		23
2 1/4	42	30					32		27
2 1/4	48	36					36		31
2 3/4	24	8					31		22
2 3/4	30	14					37		28
2 3/4	36	20					43		34
2 3/4	42	26					49		40
2 3/4	48	32					55		46

please
call
or
email
for prices

please
call
or
email
for prices

Deep Well Repair Parts Numbers 449, 449B and 852B

Description	1 3/8	1 7/8	2 1/4	2 3/4	3 3/4
11 Gauge Top Cap #449					
11 Gauge Bottom Cap #449					
Spool Plunger Valve Complete					
3 Leather					
4 Leather	N/A				
Ball Plunger Valve Complete					
3 Leather					
4 Leather	N/A				
Spool Check Valve Complete					
Ball Check Valve Complete					
Bronze Balls					
Ball size in inches	3/4"	1 1/8"	1 5/16"	1 3/4"	2 1/2"
** The Following Special Order Deep Well Repair Parts Are Available Upon Request.					
** Spool Plunger Cage					
** Ball Plunger Cage					
** Plunger Follower 3 Leather					
** Plunger Follower 4 Leather					
** Plunger Ring					
** Spool Check Cage					
** Ball Check Cage					
** Footpiece (Check Bottom)					
** Spool Poppet Complete					
** Spool Poppet Nut					
** Spool Poppet Washer					

please
call
or
email
for prices

please
call
or
email
for prices

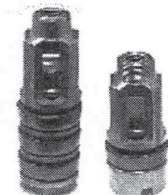
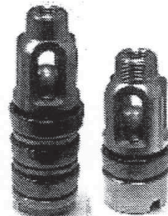
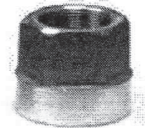
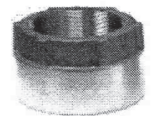

EASY PULL CYLINDERS

This cylinder has been designed to make pulling of the lower check valve easy. This is accomplished by attaching the lower spool with a stainless steel rod which is attached to the plunger valve. When the plunger valve is withdrawn it opens the lower check valve releasing the water and is then withdrawn with the plunger valve. The removal of the valve should be accomplished by an up and down or jarring movement of the rods and not a steady pull. Another feature of the lower check is that the spool can be cleaned by raising the spool off of the seat slightly and letting the water in the pipe flush back threw the lower valve. This sometimes saves pulling the whole string of pump rod. Available in #449 All Brass barrel or #852 Heavy Duty Brass barrel.

All Brass 11 Guage Easy Pull Cylinders

Inside Diameter Inches	Tubing Length Inches	Stroke Length Inches	Gallons per Stroke	All Brass Price	#19 Plunger Assem.
1 7/8	24	12	0.14	please call or email for prices	
1 7/8	30	18	0.21		
1 7/8	36	24	0.28		
1 7/8	42	30	0.35		
1 7/8	48	36	0.42		
2 1/4	24	10	0.17		
2 1/4	30	16	0.27		
2 1/4	36	22	0.37		
2 1/4	42	28	0.48		
2 1/4	48	34	0.58		
2 3/4	24	6	0.15		
2 3/4	30	12	0.30		
2 3/4	36	18	0.45		
2 3/4	42	24	0.60		
2 3/4	48	30	0.75		

852 Heavy Duty Easy Pull Cylinders

Inside Diameter Inches	Tubing Length Inches	Stroke Length Inches	Gallons per Stroke	Brass Lined Price	#19 Plunger Assem.
1 7/8	24	12	0.14	please call or email for prices	
1 7/8	30	18	0.21		
1 7/8	36	24	0.28		
1 7/8	42	30	0.35		
1 7/8	48	36	0.42		
2 1/4	24	10	0.17		
2 1/4	30	16	0.27		
2 1/4	36	22	0.37		
2 1/4	42	28	0.48		
2 1/4	48	34	0.58		
2 3/4	24	6	0.15		
2 3/4	30	12	0.30		
2 3/4	36	18	0.45		
2 3/4	42	24	0.60		
2 3/4	48	30	0.75		





Midland Mfg. Co.

Easy Pull Repair Parts

** The Following Special Order Repair Parts Are Available Upon Request.				
No.	Description	1 7/8	2 1/4	2 3/4
1	** Upper Check Cage	<p>please call or email for prices</p>		
2	** Upper Check Spool			
3	** Upper Thimble			
3A	** Upper Check Complete			
4	** Plunger Pipe Per Foot			
5	** Plunger Sleeve Coupling			
6	** Plunger Sleeve for Leathers			
7	** Plunger Ring (3 required)			
9	** Plunger Complete			
10	** Stainless Guide Rod per foot			
11	** Guide Rod Casting			
12	** Lower Check Cage			
13	** Lower Friction Plug			
14	** Lower Check Spool			
15A	** Lower Check Complete Less Guide Rod			
Note		Cylinder Barrels and Caps are same as Deep Well Parts		

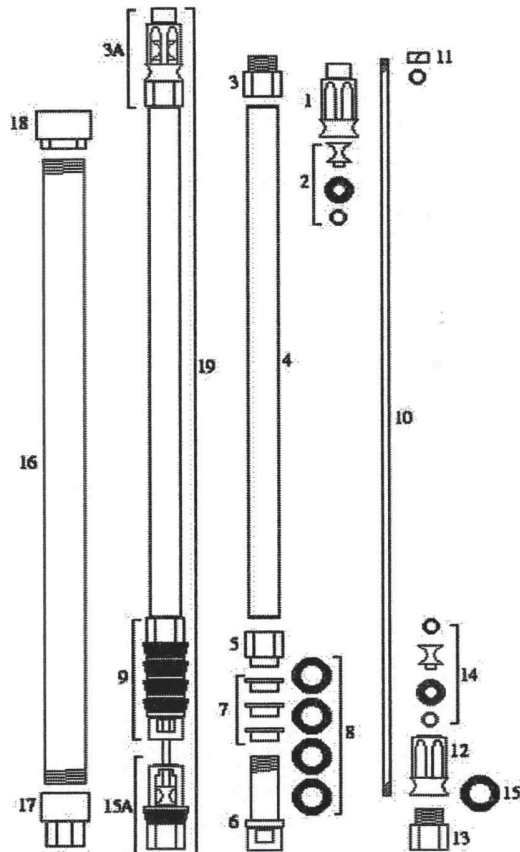

#442 & #444 All Brass Shallow Well Cylinders

The #442 is a closed top cylinder with flush caps designed for small diameter wells. Barrels are made with 11 GAUGE seamless brass tubing. The plunger is all brass with hemispherical poppet and two cup leathers. The check poppet is fitted with a special facing for a secure seal. Clearance of 2" is provided for operation at each stroke specified. Cylinders are supplied with 7/16" stainless steel rod. The #444 has the same design as the #442 except that it comes with a soft-seat poppet rather than a hemispherical poppet.

#442 & #444 All Brass Shallow Well Cylinders

Inside Diameter	Tubing Length	Stroke	Minimum Well Dia.	Gallons Per Stroke	Pipe Size	Approx. Weight	#442 List Price	#444 List Price
2	14	6	2 1/2"	.0816	1 1/4"	7	please call or email for prices	
2	16	8	2 1/2"	.1088	1 1/4"	7.75		
2	18	10	2 1/2"	.1360	1 1/4"	8.5		
2	20	12	2 1/2"	.1632	1 1/4"	9		
2 1/4	14	6	3"	.1021	1 1/4"	8	please call or email for prices	
2 1/4	16	8	3"	.1377	1 1/4"	9		
2 1/4	18	10	3"	.1721	1 1/4"	9.75		
2 1/4	20	12	3"	.2071	1 1/4"	10.5		
2 1/2	14	6	3"	.1275	1 1/4"	9	please call or email for prices	
2 1/2	16	8	3"	.1700	1 1/4"	9.5		
2 1/2	18	10	3"	.2125	1 1/4"	10		
2 1/2	20	12	3"	.2550	1 1/4"	10.5		
3	14	6	3 1/2"	.1836	1 1/4"	10	please call or email for prices	
3	16	8	3 1/2"	.2448	1 1/4"	12		
3	18	10	3 1/2"	.3060	1 1/4"	13		
3	20	12	3 1/2"	.3672	1 1/4"	14		
3 1/2	14	7	4"	.2916	2"	14	N/A	please call or email for prices
3 1/2	16	9	4"	.3749	2"	15	N/A	
3 1/2	18	11	4"	.4582	2"	16	N/A	
3 1/2	20	13	4"	.5415	2"	17	N/A	
4	14	7	5"	.3808	2"	18	N/A	please call or email for prices
4	16	9	5"	.4896	2"	19	N/A	
4	18	11	5"	.5984	2"	20	N/A	
4	20	13	5"	.7072	2"	21	N/A	





REPAIR PARTS FOR ALL BRASS SHALLOW WELL CYLINDERS #442 AND #444 - FLUSH THREAD

Inside Thread Barrel Less Caps	2	2 1/4	2 1/2	3	3 1/2	4
14" Long						
16" Long						
18" Long						
20" Long						
22" Long						
24" Long						

**please call
or email
for prices**

Repair Parts	2	2 1/4	2 1/2	3	3 1/2	4
Flush Top Caps						
Flush Bottom Caps						
Plunger Cage						
Plunger Follower						
Plunger Poppet for #422						
Plunger Poppet for #444						
Plunger Rings						
Stel Plunger Rod						
Brass Plunger Rod						
Brass Hex Locking Nut						
Plunger Complete / Less Rod						
Plunger Complete / Less Rod #444						
Flat Spider Cage for Flush Cylinder						
Check Poppet for #442 & #444						
Facing for #442 & #444 Poppet						

MIDLAND STUFFING BOXES / PACKED

Product Description	Pipe Size	Approx. Weight		3/4" x 18" Stainless Rod
Stuffing Box / 5/8" Thread - Packed	1 1/4"	4		*
Stuffing Box / 5/8" Thread - Packed	2"	4.75		

Repair Parts for Stuffing Box	Price
1 1/4" Replacement Body Only - Unpacked	* please call or email for prices
2" Replacement Body Only - Unpacked	
Stainless Steel Rod	
Nuts	
Glands	

MIDLAND HEAVY SERVICE STUFFING BOXES / PACKED

Product Description	Pipe Size	Approx. Weight		1-1/16" x 4' Stainless Rod
Heavy Service Stuffing Box / 7/8" Thread - Packed	2"	16		*
Heavy Service Stuffing Box / 7/8" Thread - Packed	2 1/2"	18		
Heavy Service Stuffing Box / 7/8" Thread - Packed	3"	19		

Repair Parts for Heavy Service Stuffing Box	Price
2" HS Replacement Body Only - Unpacked	* please call or email for prices
2 1/2" HS Replacement Body Only - Unpacked	
3" HS Replacement Body Only - Unpacked	
Stainless Steel Rod	
Nuts For 2" HS Stuffing Box	
Nuts For 2 1/2" & 3" HS Stuffing Boxes	
Glands For 2" HS Stuffing Box	
Glands For 2 1/2" & 3" HS Stuffing Boxes	

MIDLAND SPRING LOADED STUFFING BOX

Product Description	Pipe Size	Approx. Weight		Stainless Rod
2" S.L. Stuffing Box / 5/8" Thread	2"			*

Repair Parts for S.L. Stuffing Box	Price
2" S.L. Replacement Body Only	* please call or email for prices
Nuts	
Glands (1 Set, Top & Bottom)	
Spring	
V-rings	

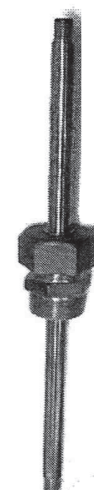
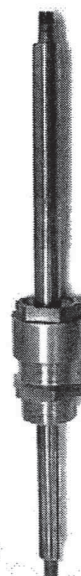



MIDLAND INVERTED BRASS TUBE STUFFING BOXES

Product Description	Price
No. 1 IBT 1" Iron Pipe Size Brass Pipe 14" Long. Threaded one end standard pipe thread. 4 leather plunger, 7/16" steel plunger rod 20" long with windmill connection at top. Approx. weight 4 lbs.	*
No. 2 IBT 1 1/8" Inside Dia. Brass Tube 13" long, 2" Brass pipe connection at top, 8" stroke, 3 leather plunger, 5/8" steel plunger rod with 5/8" standard thread. Approx. weight 5 lbs.	*
No. 3 IBT 1 1/8" Inside Dia. Brass Tube 18" long, 2" Brass pipe connection at top, 12" stroke, 3 leather plunger, 5/8" steel plunger rod with 5/8" standard thread. Approx. weight 6 lbs.	*
No. 4 IBT 2" x 18" No. 4 IBT 2 1/2" x 18" 1 3/8" Inside Dia. Brass Tube 18" long, 2" or 2 1/2" brass pipe connection at top, 12" stroke, 3 leather plunger, 5/8" steel plunger rod with 5/8" standard thread. Approx. weights, 2" - 8 lbs., 2 1/2" - 9 lbs.	*
No. 5 IBT 2 1/2" x 24" No. 5 IBT 3" x 24" 1 7/8" Inside Dia. Brass Tube 24" long, 2 1/2" or 3" Brass pipe busing at top, 18" stroke, 3 leather plunger, 7/8" steel plunger rod with 7/8" standard thread. Approx. weights, 2 1/2" - 16 lbs., 3" - 18 lbs.	*

Repair Parts for IBT Stuffing Boxes	No. 1	No. 2	No. 3	No. 4	No. 5
Barrels	* please call or email for prices				
2" Bushing					
2 1/2" Bushing					
3" Bushing					
Plunger Complete					
Flat Spacers					
Nuts					
Plunger Rings					
Plunger Rod					



TABLE SHOWING AMOUNT OF WATER DISCHARGED PER STROKE BY SINGLE ACTING CYLINDER

Diameter of Cylinder	Length of Stroke in Inches With Capacity Per Stroke in Gallons									
	3"	4"	5"	6"	7"	8"	10"	12"	18"	24"
1-3/8"	0.0192	0.0256	0.0320	0.0384	0.0448	0.0512	0.0640	0.0768	0.1152	0.1536
1-7/8"	0.0360	0.0480	0.0600	0.0720	0.0840	0.0960	0.1200	0.1440	0.2160	0.2880
2"	0.0408	0.0544	0.0680	0.0816	0.0952	0.1088	0.1360	0.1632	0.2448	0.3264
2-1/4"	0.0516	0.0688	0.0860	0.1033	0.1205	0.1377	0.1721	0.2071	0.3104	0.4137
2-1/2"	0.0637	0.0850	0.1062	0.1275	0.1487	0.1700	0.2125	0.2550	0.3825	0.5100
2-3/4"	0.0771	0.1028	0.1285	0.1543	0.1800	0.2057	0.2571	0.3085	0.4628	0.6171
3"	0.0918	0.1224	0.1530	0.1836	0.2142	0.2448	0.3060	0.3672	0.5508	0.7344
3-1/2"	0.1249	0.1666	0.2082	0.2499	0.2915	0.3332	0.4165	0.4998	0.7497	0.9996
4"	0.1632	0.2176	0.2720	0.3264	0.3808	0.4352	0.5440	0.6528	0.9792	1.3056



Midland  **Mfg. Co.**

MIDLAND FLOAT VALVES

Product Number	Product Description	List Price
----------------	---------------------	------------

MIDLAND FLOAT VALVES

M09102	3/4" Midland Float Valve	please call or email for prices
M09103	1" Midland Float Valve	
M09104	1 1/4" Midland Float Valve	
M09105	1 1/2" Midland Float Valve	
M09106	2" Midland Float Valve	
M09107	2 1/2" Midland Float Valve	
M09108	3" Midland Float Valve	
M09110	4" Midland Float Valve	

MIDLAND FLOAT VALVE - REPLACEMENT HANDLE

M09212	3/4" Midland FV Handle	please call or email for prices
M09213	1" Midland FV Handle	
M09214	1 1/4" Midland FV Handle	
M09215	1 1/2" Midland FV Handle	
M09216	2" Midland FV Handle	
M09217	2 1/2" Midland FV Handle	
M09218	3" Midland FV Handle	
M09220	4" Midland FV Handle	

MIDLAND FLOAT - REPLACEMENT LEATHER WASHER

M09712	3/4" Midland FV Leather Washer	please call or email for prices
M09713	1" Midland FV Leather Washer	
M09714	1 1/4" Midland FV Leather Washer	
M09715	1 1/2" Midland FV Leather Washer	
M09716	2" Midland FV Leather Washer	
M09717	2 1/2" Midland FV Leather Washer	
M09718	3" Midland FV Leather Washer	
M09720	4" Midland FV Leather Washer	

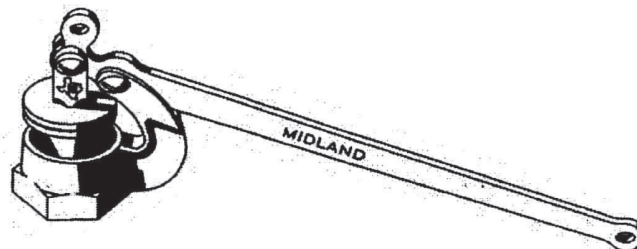



Q-43

FLIPPEN FLOAT VALVES

Product Number	Product Description	List Price
----------------	---------------------	------------

FLIPPEN FLOAT VALVES

111205	1/2" Flippen Float Valve - 1/4" Stem	please call or email for prices
111210	3/4" Flippen Float Valve - 1/4" Stem	
111215	1" Flippen Float Valve - 5/16" Stem	
111220	1 1/4" Flippen Float Valve - 3/8" Stem	
111225	1 1/2" Flippen Float Valve - 3/8" Stem	
111230	2" Flippen Float Valve - 3/8" Stem	



FLIPPEN FLOAT VALVE - STEMS & ROD STOPS

111235	No. 11 - 1/4" x 1/4" Stem	please call or email for prices
111240	No. 11.5 - 1/4" x 5/16" Stem	
111245	No. 12 - 5/16" x 5/16" Stem	
111250	No. 12.5 - 5/16" x 3/8" Stem	
111255	No. 13 - 3/8" x 3/8" Stem	
111295	1/4" Brass Rod Stop	
111300	1/4" Steel Rod Stop	

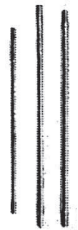

FLIPPEN FLOAT VALVES - NUZZEL ASSEMBLIES

111260	No. N-1 - 1/4" x 1/4" Nuzzle Assembly	please call or email for prices
111262	No. N-1-7 - 1/4" x 5/16" Nuzzle Assembly	
111263	No. N-5 - 5/16" x 5/16" Nuzzle Assembly	
111264	No. N-5-3 - 5/16" x 3/8" Nuzzle Assembly	
111265	No. N-8 - 3/8" x 3/8" Nuzzle Assembly	



BALL FLOATS

111425	6" Plastic Ball With Threaded Spud - 5/16"	please call or email for prices
111430	6" Plastic Ball With Threaded Spud - 1/4"	
111440	8" Plastic Ball With Threaded Spud - 5/16"	
111435	8" Plastic Ball With Threaded Spud - 3/8"	



111450	6" Copper Ball With Threaded Spud - 1/4"	please call or email for prices
111452	6" Copper Ball With Threaded Spud - 5/16"	
111455	8" Copper Ball With Threaded Spud - 3/8"	

POLY TANK FLOATS - FOAM LINED

111470	12" Poly Tank Pan Float	please call or email for prices
111471	Pgtail Tie Tod	
111473	5/16" Brass Rod with Lug	
111475	3/8" Brass Rod with Lug	

Pan Float Pictured
with Pigtail
& Tie Rod



Pigtail Tie Rod



Brass Rod with Lug



FLIPPEN FLOAT VALVE - PARTS

Valve Arms for 3/8", 1/2" 3/4"



Part Number	Thread Size
1MN	N/A
2MN-1	1/4 - 20
2MN-7	5/16 - 18
2MN-3	3/8 - 16
2MN-9	1/8

Valve Arms for 1" through 2"



Part Number	Thread Size
1JB	N/A
2JB-1	1/4 - 20
2JB-7	5/16 - 18
2JB-3	3/8 - 16
2JB-9	1/8 NPSF
2JB-4	1/4 NPSF

Valve Arm Set



Assembly Number	Size (Inches)
A1214	3/8, 1/2, 3/4
A1210	1" (larger)

Leather Rings



Valve Size	Part Number
3/8"	375-8
1/2"	500-8
3/4"	750-8
1"	500-8
1 1/4"	500-8
1 1/2"	500-8
2"	500-8

Plunger Disks (Rubber)



Valve Size	Part Number
3/8"	375-5
1/2"	500-5
3/4"	750-5
1"	1000-5
1 1/4"	J-5
1 1/2"	J-5
2"	J-5

Plunger Assembly

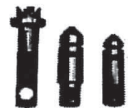

Valve Size	Part Number
3/8"	375-A785
1/2"	500-A785
3/4"	750-A785
1"	1000-A785
1 1/4"	J-A785
1 1/2"	J-A785
2"	J-A785

Bulkhead Locknuts



Valve Size	Part Number
3/8"	375-6
1/2"	500-6
3/4"	750-6

Bulkhead Gaskets



Valve Size	Part Number
3/8"	700223
1/2"	700225
3/4"	700226

Thumb Screws



Valve Size	Part Number
3/8"	15
1/2"	15
3/4"	15

Machine Screws



Valve Size	Part Number
1"	10
1 1/4"	10
1 1/2"	10
2"	10

Nut & Bolt Assembly



Valve Size	Part Number
3/8"	3B
1/2"	3B
3/4"	3B
1"	4B
1 1/4"	4B
1 1/2"	4B
2"	4B

Parts Available Upon Request - CALL FOR CURRENT PRICES



FLOAT VALVES

Product Number	Product Description	List Price
LEWIS FLOAT VALVES		
111342	1" Lewis Float Valve - Less Float	**
111343	1 1/4" Lewis Float Valve - Less Float	
111345	3/4" Lewis Float Valve With Bleeder - Less Float	**
111344	1" Lewis Float Valve With Bleeder - Less Float	
111371	12" Lewis Aluminum Float with Chain	**
111369	Lewis Float Valve - Repair Washer	
111372	Lewis Float Valve - Deflector Cap	
111375	1" Lewis Float Valve Riser Kit	**
111377	1 1/4" Lewis Float Valve Riser Kit	
111379	3/4" Lewis Float Valve Side Mount Kit	**

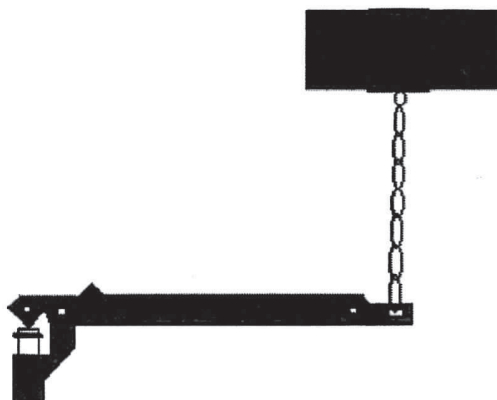

****please
call or
email
for prices**

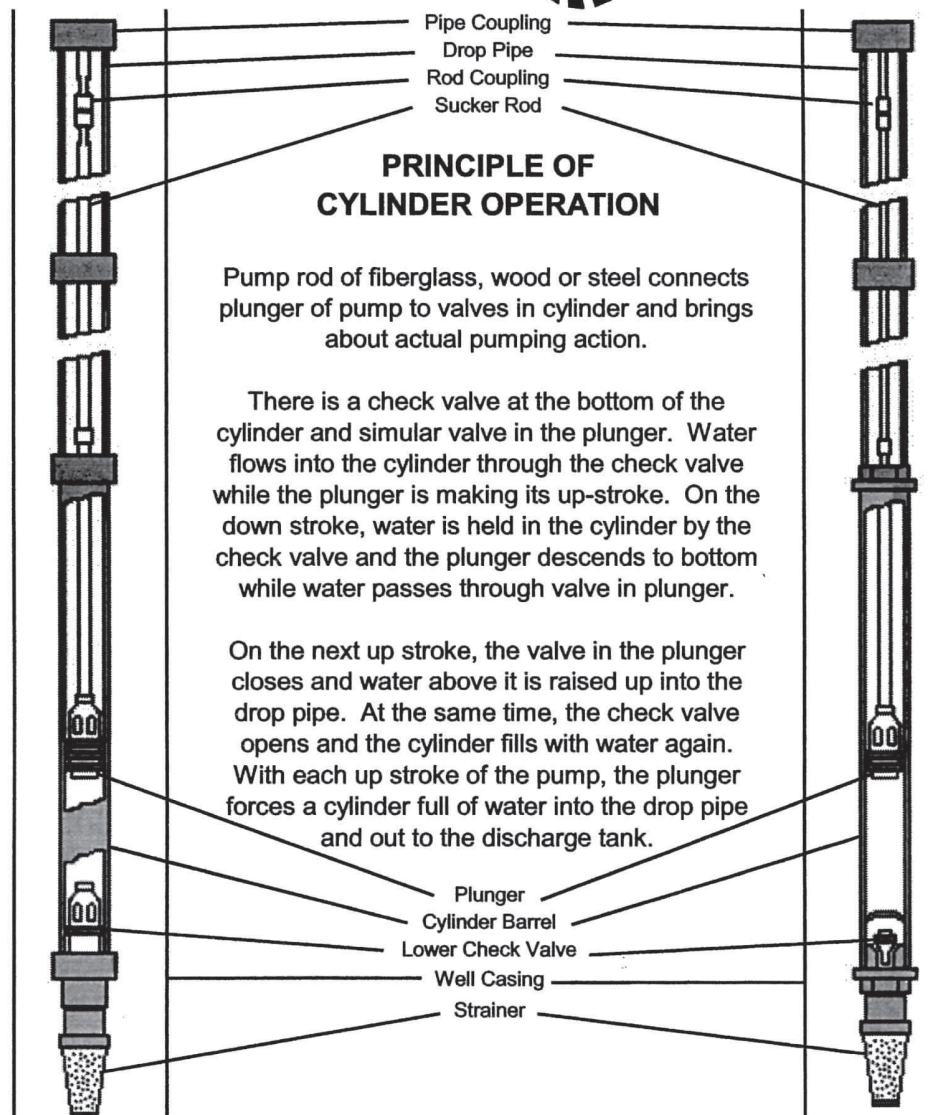

OPEN TOP CYLINDER SELECTION

Open top cylinders are recommended where it can be used. Inside diameter of the drop pipe is slightly larger than inside diameter of the cylinder. This permits lowering or removal of the plunger and check valve through the drop pipe.

CLOSED TOP CYLINDER SELECTION

Closed top cylinders are used in shallow well applications where the drop pipe size can be reduced. Removal of the plunger requires the drop pipe to be removed from the well.



INSTALLATION OF SUBMERSIBLE PUMP BELOW CYLINDER PUMP

